

01 TOP VIEW

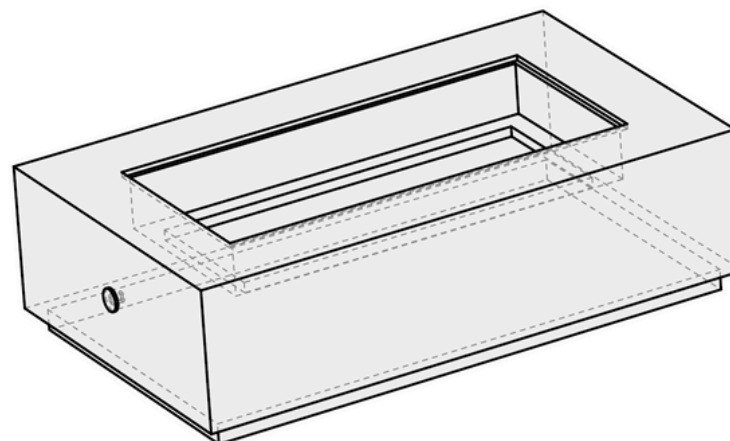

04 PERSPECTIVE

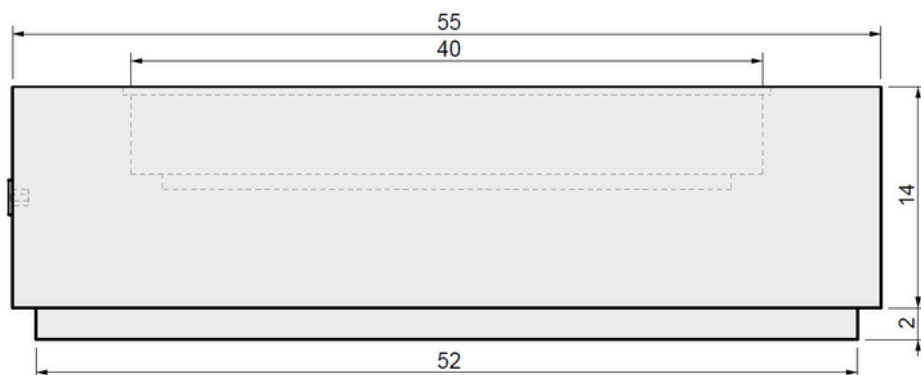

02 FRONT VIEW

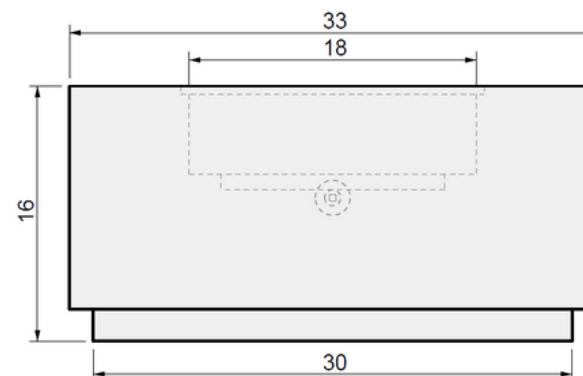

03 SIDE VIEW



CONFIDENTIAL

Any information data and drawings embodied in this document are proprietary and strictly confidential, are to be held as confidential and supplied with the understanding that they will not be disclosed, in whole or in part or in any form, to third parties without the prior written consent of Montana Fire Pits. All information, illustrations, screen shots, and data contained are herein Copyright © Montana Fire Pits. All rights reserved.

Model: Lumera Fire Table

Size: 55" L x 33" W x 16" H

Material: GFRC

Burner: CFBL150 - 150K BTU Linear Burner

Fuel Pressure: Natural Gas: 7" Water Column
Propane: 11" Water Column

Weight: 250 lbs.

Burner Detail

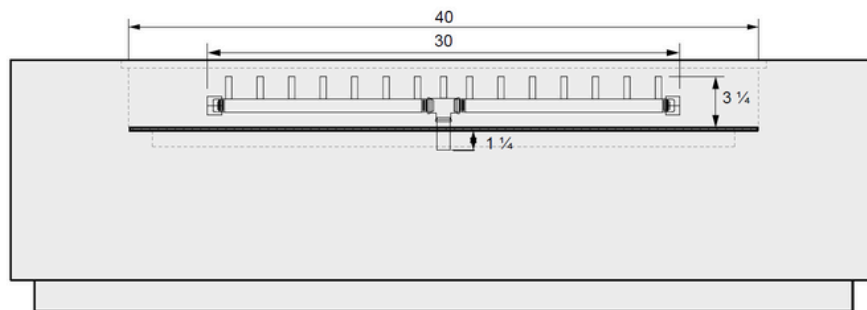

01 SIDE VIEW

Plate Detail

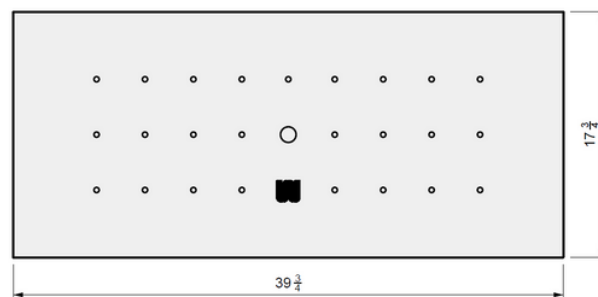

01 TOP VIEW

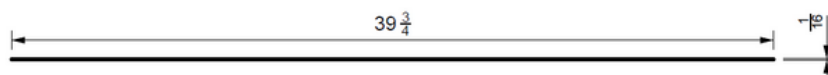

02 FRONT VIEW

BURNER SPECS

LINEAR CFBL150
Dimensions: 30" x 1"
150,000 BTU

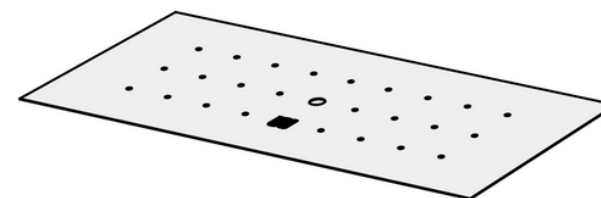
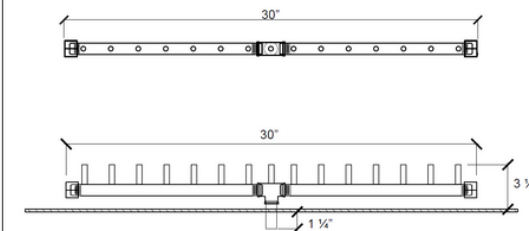

04 PERSPECTIVE

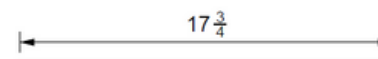

03 SIDE VIEW



CONFIDENTIAL

Any information data and drawings embodied in this document are proprietary and strictly confidential, are to be held as confidential and supplied with the understanding that they will not be disclosed, in whole or in part or in any form, to third parties without the prior written consent of Montana Fire Pits. All information, illustrations, screen shots, and data contained are herein Copyright © Montana Fire Pits. All rights reserved.

Model: Lumera Fire Table

Size: 55" L x 33" W x 16" H

Material: GFRC

Burner: CFBL150 - 150K BTU Linear Burner

Fuel Pressure: Natural Gas: 7" Water Column
Propane: 11" Water Column

Weight: 250 lbs.



01 TOP VIEW

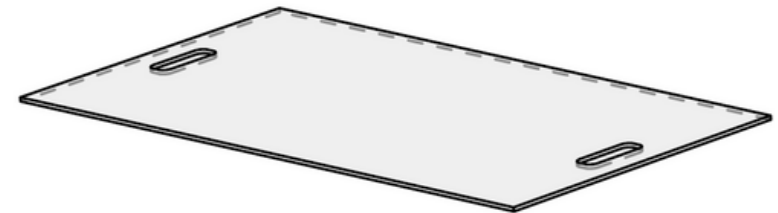

04 PERSPECTIVE

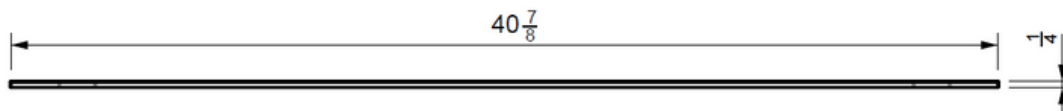

02 FRONT VIEW

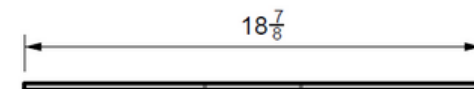

03 SIDE VIEW



CONFIDENTIAL

Any information data and drawings embodied in this document are proprietary and strictly confidential, are to be held as confidential and supplied with the understanding that they will not be disclosed, in whole or in part or in any form, to third parties without the prior written consent of Montana Fire Pits. All information, illustrations, screen shots, and data contained are herein Copyright © Montana Fire Pits. All rights reserved.

Model: Cover For 55" x 33" Lumera Fire Table Fire Table

Material: Powder Coated Aluminum

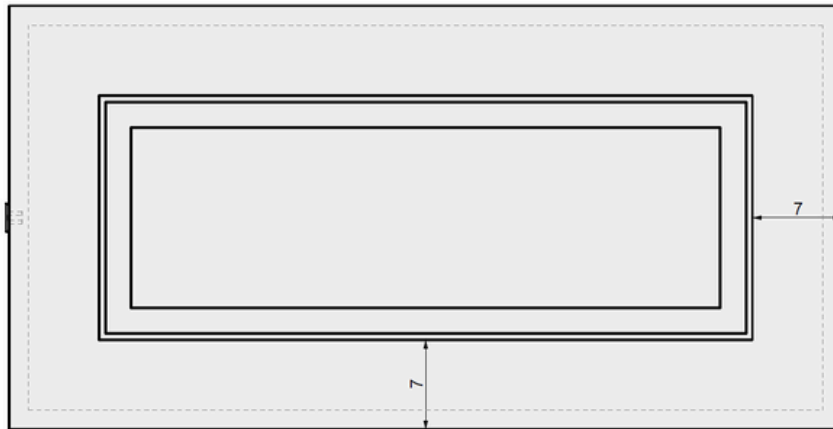

01 TOP VIEW

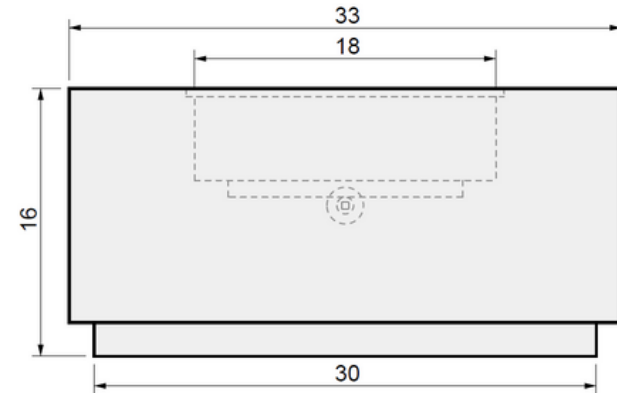

03 SIDE VIEW

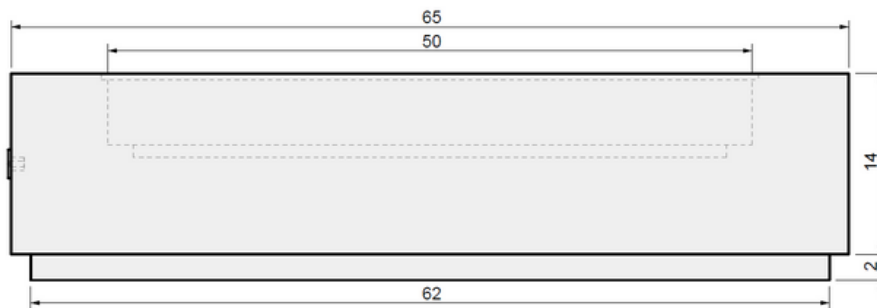

02 FRONT VIEW

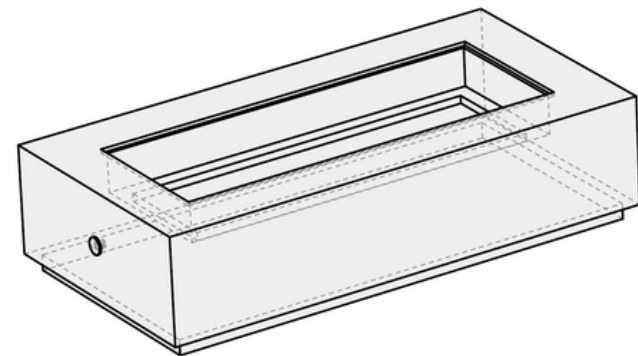

04 PERSPECTIVE



CONFIDENTIAL

Any information data and drawings embodied in this document are proprietary and strictly confidential, are to be held as confidential and supplied with the understanding that they will not be disclosed, in whole or in part or in any form, to third parties without the prior written consent of Montana Fire Pits. All information, illustrations, screen shots, and data contained are herein Copyright © Montana Fire Pits. All rights reserved.

Model: Lumera Fire Table

Size: 65" L x 33" W x 16" H

Material: GFRC

Burner: CFBL210 - 210K BTU Linear Burner

Fuel Pressure: Natural Gas: 7" Water Column
Propane: 11" Water Column

Weight: 400 lbs.

Burner Detail

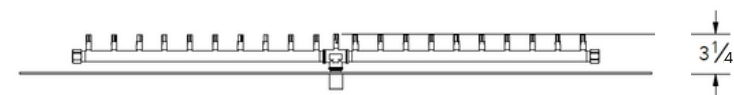
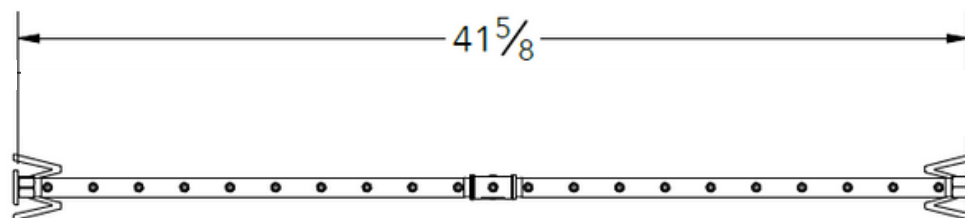
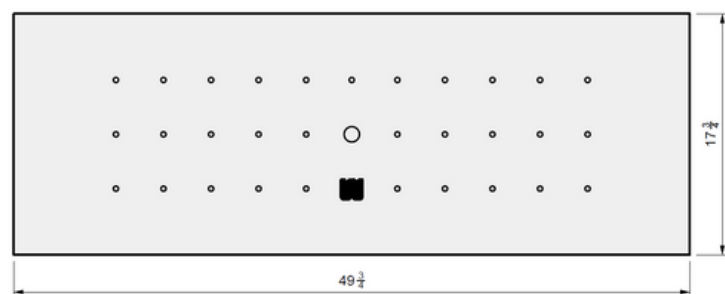
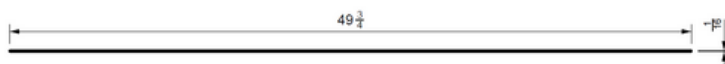

Plate Detail



01 TOP VIEW



02 FRONT VIEW

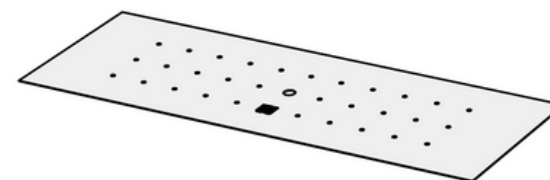

04 PERSPECTIVE



03 SIDE VIEW



CONFIDENTIAL

Any information data and drawings embodied in this document are proprietary and strictly confidential, are to be held as confidential and supplied with the understanding that they will not be disclosed, in whole or in part or in any form, to third parties without the prior written consent of Montana Fire Pits. All information, illustrations, screen shots, and data contained are herein Copyright © Montana Fire Pits. All rights reserved.

Model: Lumera Fire Table

Size: 65" L x 33" W x 16" H

Material: GFRC

Burner: CFBL210 - 210K BTU Linear Burner

Fuel Pressure: Natural Gas: 7" Water Column
Propane: 11" Water Column

Weight: 400 lbs.



01 TOP VIEW

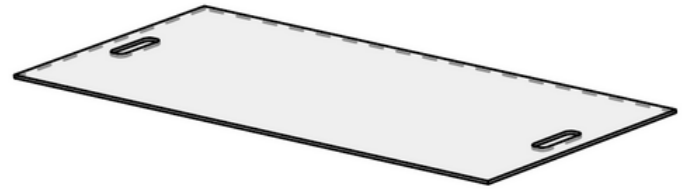

04 PERSPECTIVE

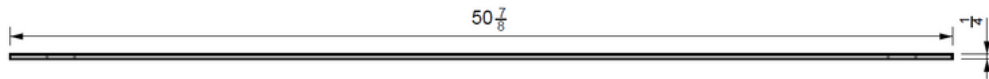

02 FRONT VIEW

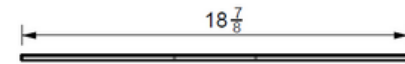

03 SIDE VIEW



CONFIDENTIAL

Any information data and drawings embodied in this document are proprietary and strictly confidential, are to be held as confidential and supplied with the understanding that they will not be disclosed, in whole or in part or in any form, to third parties without the prior written consent of Montana Fire Pits. All information, illustrations, screen shots, and data contained are herein Copyright © Montana Fire Pits. All rights reserved.

Model: Cover For 65" x 33" Lumera Fire Table Fire Table

Material: Powder Coated Aluminum

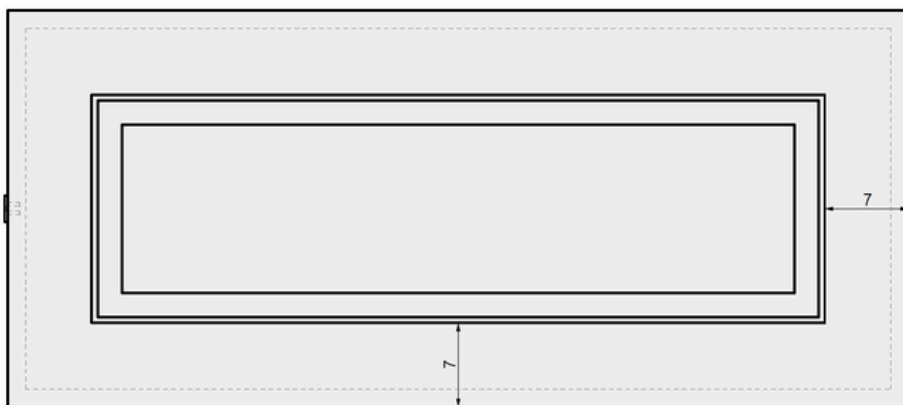

01 TOP VIEW

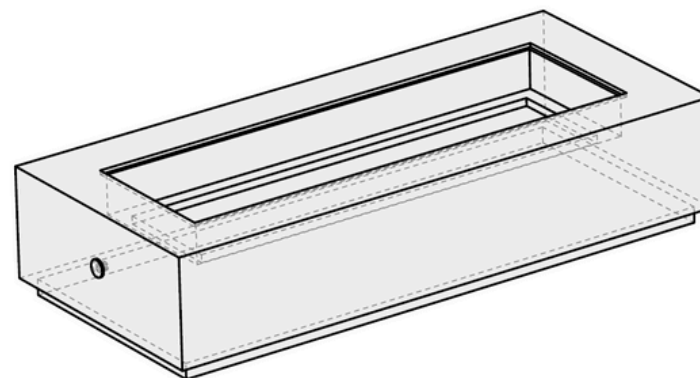

04 PERSPECTIVE

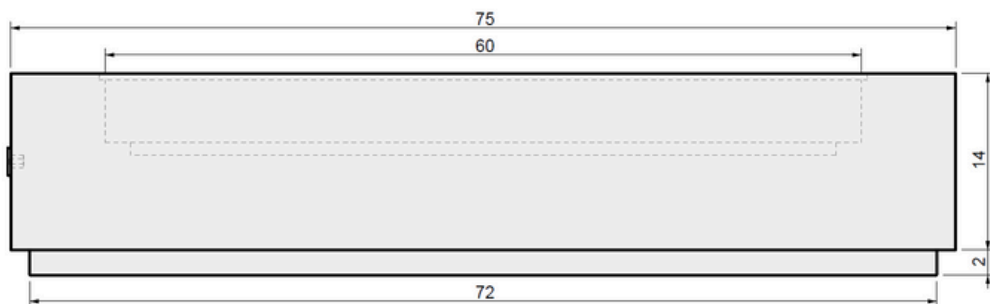

02 FRONT VIEW

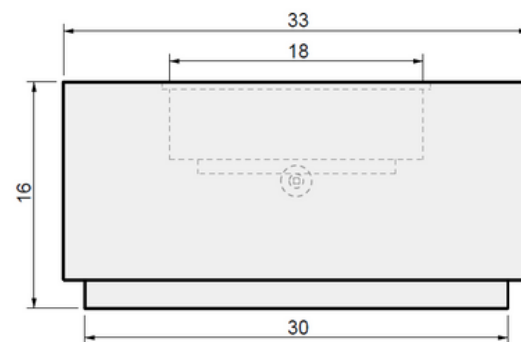

03 SIDE VIEW



CONFIDENTIAL

Any information data and drawings embodied in this document are proprietary and strictly confidential, are to be held as confidential and supplied with the understanding that they will not be disclosed, in whole or in part or in any form, to third parties without the prior written consent of Montana Fire Pits. All information, illustrations, screen shots, and data contained are herein Copyright © Montana Fire Pits. All rights reserved.

Model: Lumera Fire Table

Size: 75" L x 33" W x 16" H

Material: GFRC

Burner: CFBL250 - 250K BTU Linear Burner

Fuel Pressure: Natural Gas: 7" Water Column
Propane: 11" Water Column

Weight: 450 lbs.

Burner Detail

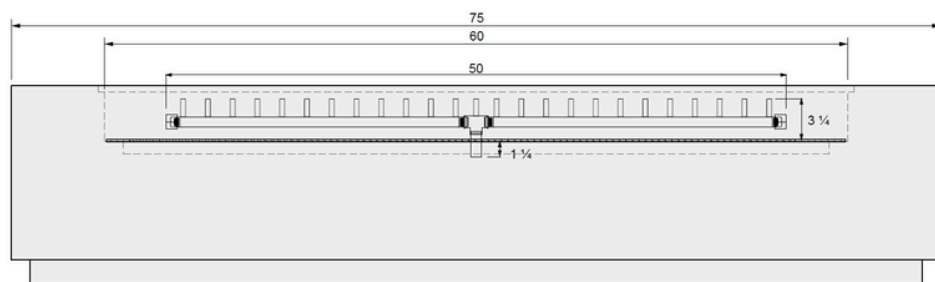

01 SIDE VIEW

BURNER MODEL

LINEAR CFBL250
Dimensions: 50" x 1"
250,000 BTU

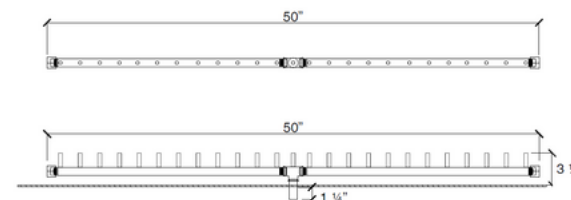
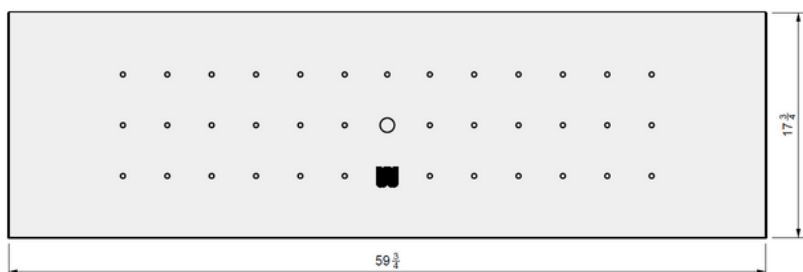
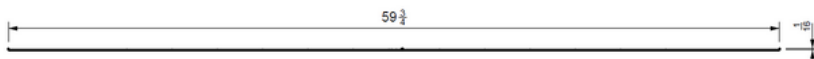

Plate Detail



01 TOP VIEW



02 FRONT VIEW

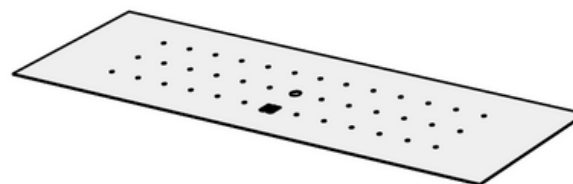

04 PERSPECTIVE

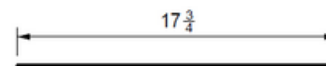

03 SIDE VIEW



CONFIDENTIAL

Any information data and drawings embodied in this document are proprietary and strictly confidential, are to be held as confidential and supplied with the understanding that they will not be disclosed, in whole or in part or in any form, to third parties without the prior written consent of Montana Fire Pits. All information, illustrations, screen shots, and data contained are herein Copyright © Montana Fire Pits. All rights reserved.

Model: Lumera Fire Table

Size: 75" L x 33" W x 16" H

Material: GFRC

Burner: CFBL250 - 250K BTU Linear Burner

Fuel Pressure: Natural Gas: 7" Water Column
Propane: 11" Water Column

Weight: 450 lbs.

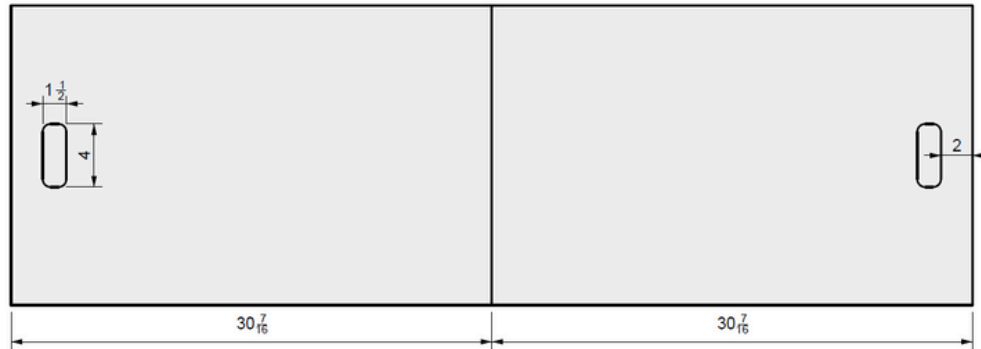

01 TOP VIEW

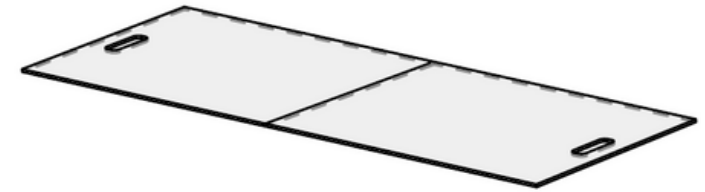

04 PERSPECTIVE

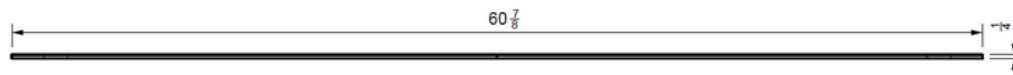

02 FRONT VIEW

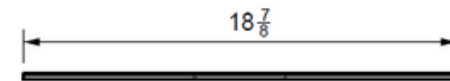

03 SIDE VIEW



CONFIDENTIAL

Any information data and drawings embodied in this document are proprietary and strictly confidential, are to be held as confidential and supplied with the understanding that they will not be disclosed, in whole or in part or in any form, to third parties without the prior written consent of Montana Fire Pits. All information, illustrations, screen shots, and data contained are herein Copyright © Montana Fire Pits. All rights reserved.

Model: Cover For 75" x 33" Lumera Fire Table Fire Table

Material: Powder Coated Aluminum

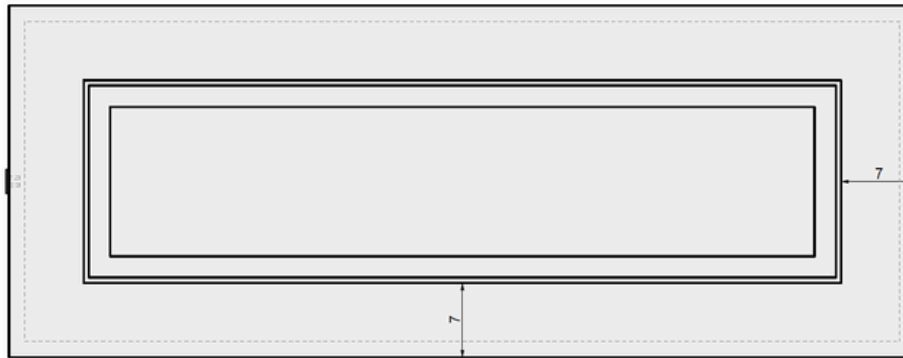

01 TOP VIEW

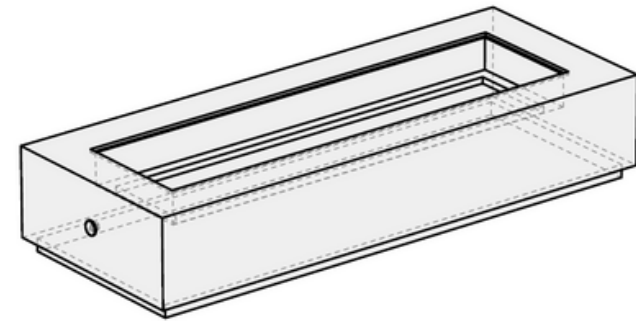

04 PERSPECTIVE

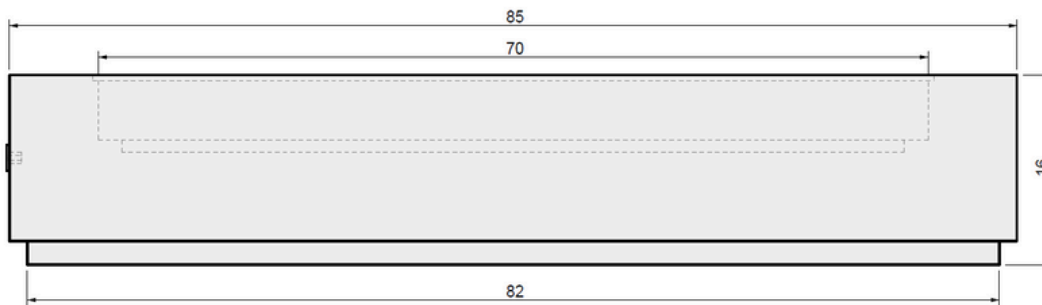

02 FRONT VIEW

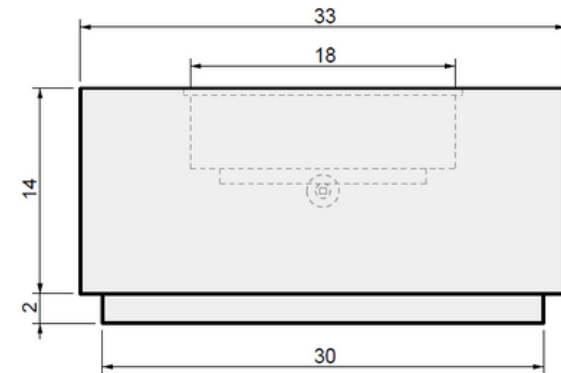

03 SIDE VIEW



CONFIDENTIAL

Any information data and drawings embodied in this document are proprietary and strictly confidential, are to be held as confidential and supplied with the understanding that they will not be disclosed, in whole or in part or in any form, to third parties without the prior written consent of Montana Fire Pits. All information, illustrations, screen shots, and data contained are herein Copyright © Montana Fire Pits. All rights reserved.

Model: Lumera Fire Table

Size: 85" L x 33" W x 16" H

Material: GFRC

Burner: CFBL270 - 270K BTU Linear Burner

Fuel Pressure: Natural Gas: 7" Water Column
Propane: 11" Water Column

Weight: 500 lbs.

Burner Detail

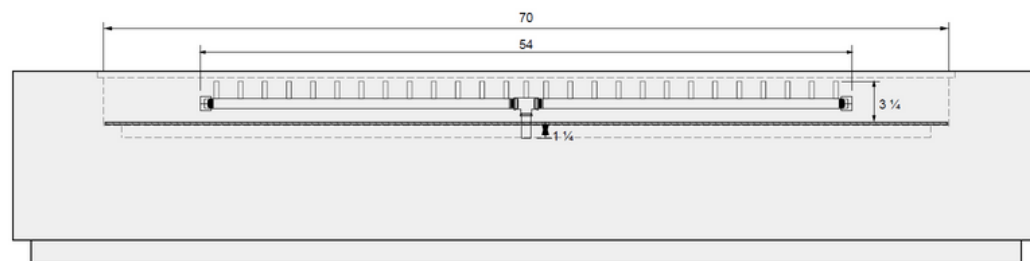

01 SIDE VIEW

Plate Detail

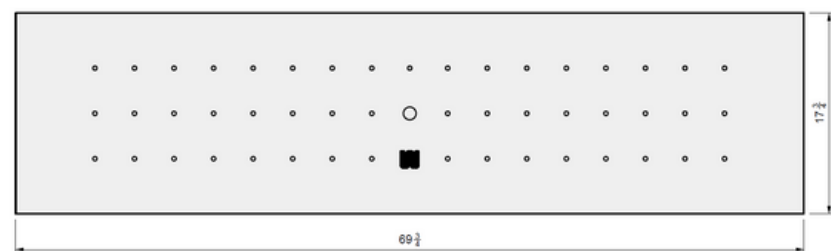

01 TOP VIEW

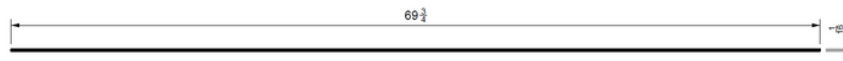

02 FRONT VIEW

BURNER MODEL

LINEAR CFBL270
Dimensions: 54" x 1"
270,000 BTU

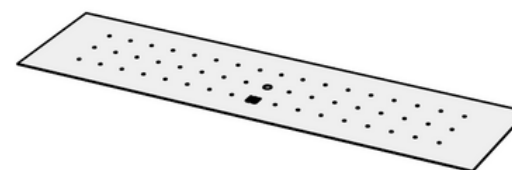
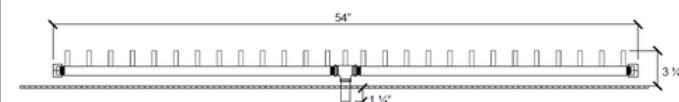

04 PERSPECTIVE



03 SIDE VIEW



CONFIDENTIAL

Any information data and drawings embodied in this document are proprietary and strictly confidential, are to be held as confidential and supplied with the understanding that they will not be disclosed, in whole or in part or in any form, to third parties without the prior written consent of Montana Fire Pits. All information, illustrations, screen shots, and data contained are herein Copyright © Montana Fire Pits. All rights reserved.

Model: Lumera Fire Table

Size: 85" L x 33" W x 16" H

Material: GFRC

Burner: CFBL270 - 270K BTU Linear Burner

Fuel Pressure: Natural Gas: 7" Water Column
Propane: 11" Water Column

Weight: 500 lbs.

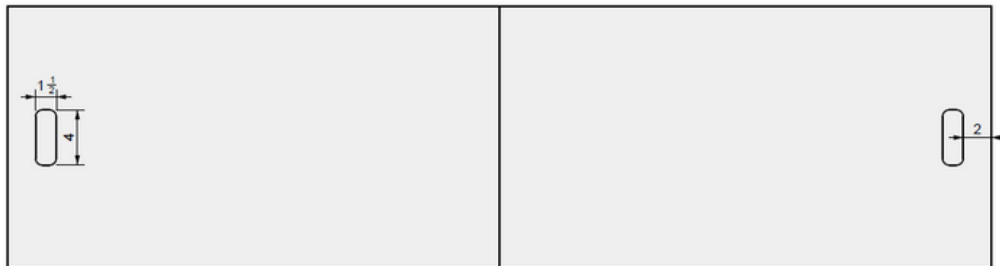

01 TOP VIEW

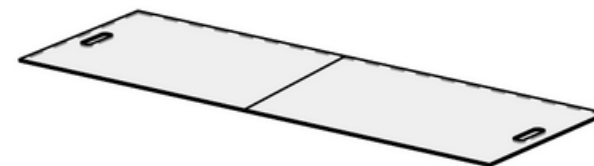

04 PERSPECTIVE

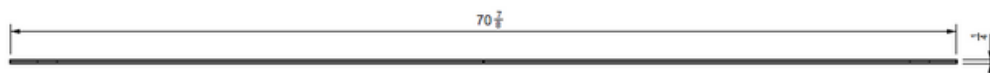

02 FRONT VIEW

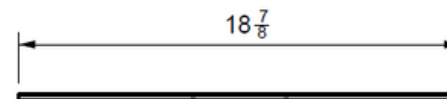

03 SIDE VIEW



CONFIDENTIAL

Any information data and drawings embodied in this document are proprietary and strictly confidential, are to be held as confidential and supplied with the understanding that they will not be disclosed, in whole or in part or in any form, to third parties without the prior written consent of Montana Fire Pits. All information, illustrations, screen shots, and data contained are herein Copyright © Montana Fire Pits. All rights reserved.

Model: Cover For 85" x 33" Lumera Fire Table Fire Table

Material: Powder Coated Aluminum

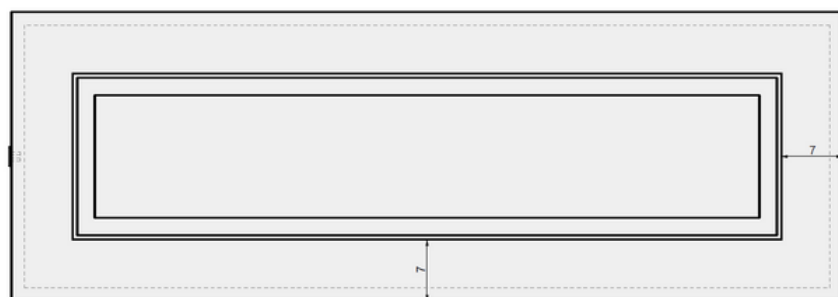

01 TOP VIEW

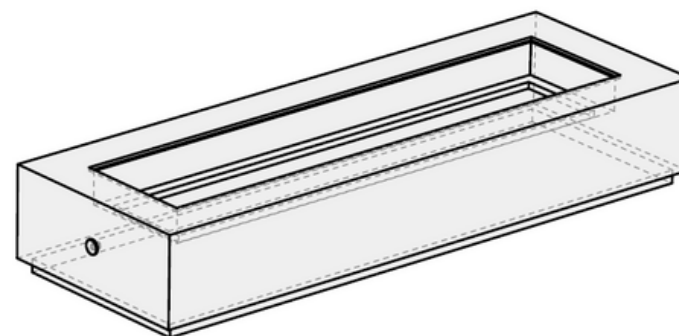

04 PERSPECTIVE

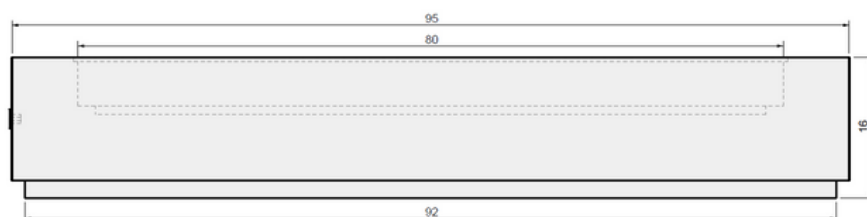

02 FRONT VIEW

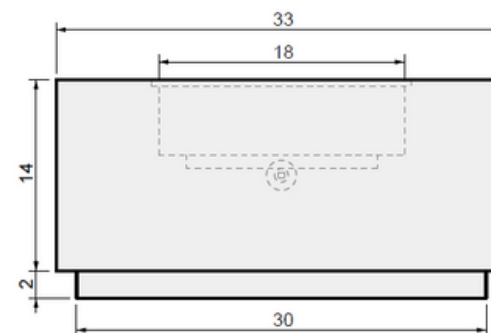

03 SIDE VIEW



CONFIDENTIAL

Any information data and drawings embodied in this document are proprietary and strictly confidential, are to be held as confidential and supplied with the understanding that they will not be disclosed, in whole or in part or in any form, to third parties without the prior written consent of Montana Fire Pits. All information, illustrations, screen shots, and data contained are herein Copyright © Montana Fire Pits. All rights reserved.

Model: Lumera Fire Table

Size: 95" L x 33" W x 16" H

Material: GFRC

Burner: CFBL310 – 310K BTU Linear Burner

Fuel Pressure: Natural Gas: 7" Water Column
Propane: 11" Water Column

Weight: 575 lbs.

Plate Detail

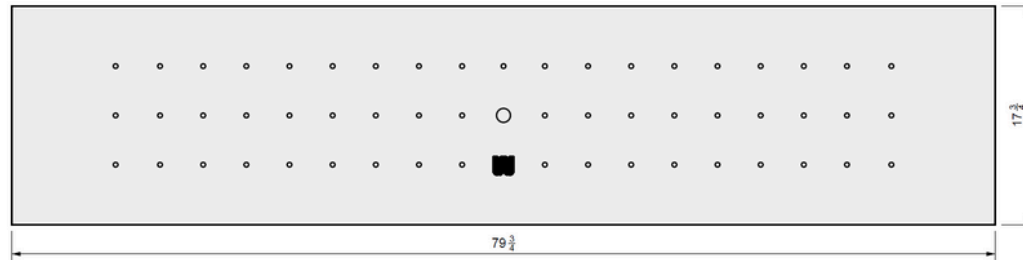

01 TOP VIEW

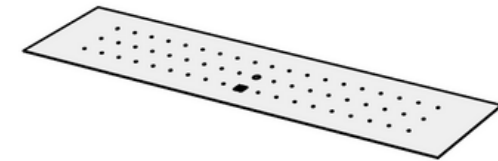

04 PERSPECTIVE

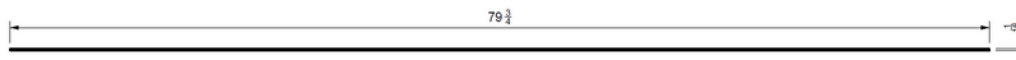

02 FRONT VIEW



03 SIDE VIEW



CONFIDENTIAL

Any information data and drawings embodied in this document are proprietary and strictly confidential, are to be held as confidential and supplied with the understanding that they will not be disclosed, in whole or in part or in any form, to third parties without the prior written consent of Montana Fire Pits. All information, illustrations, screen shots, and data contained are herein Copyright © Montana Fire Pits. All rights reserved.

Model: Lumera Fire Table

Size: 95" L x 33" W x 16" H

Material: GFRC

Burner: CFBL310 – 310K BTU Linear Burner

Fuel Pressure: Natural Gas: 7" Water Column
Propane: 11" Water Column

Weight: 575 lbs.



01 TOP VIEW

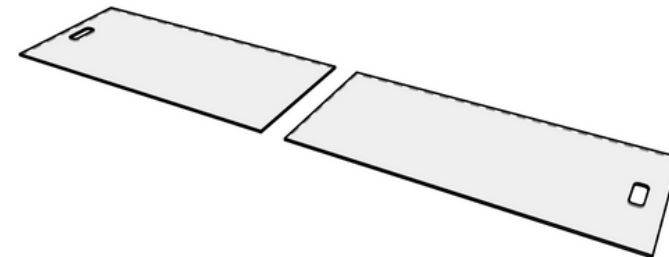

04 PERSPECTIVE

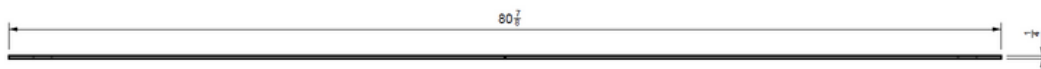

02 FRONT VIEW



03 SIDE VIEW



CONFIDENTIAL

Any information data and drawings embodied in this document are proprietary and strictly confidential, are to be held as confidential and supplied with the understanding that they will not be disclosed, in whole or in part or in any form, to third parties without the prior written consent of Montana Fire Pits. All information, illustrations, screen shots, and data contained are herein Copyright © Montana Fire Pits. All rights reserved.

Model: Cover For 95" x 33" Lumera Fire Table Fire Table

Material: Powder Coated Aluminum