

01 TOP VIEW

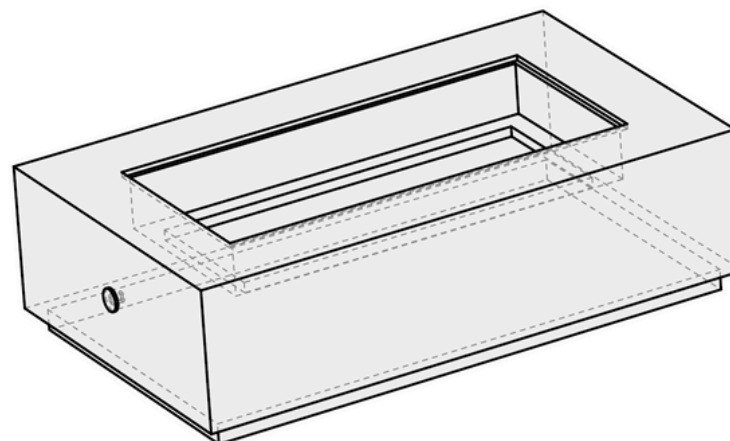

04 PERSPECTIVE

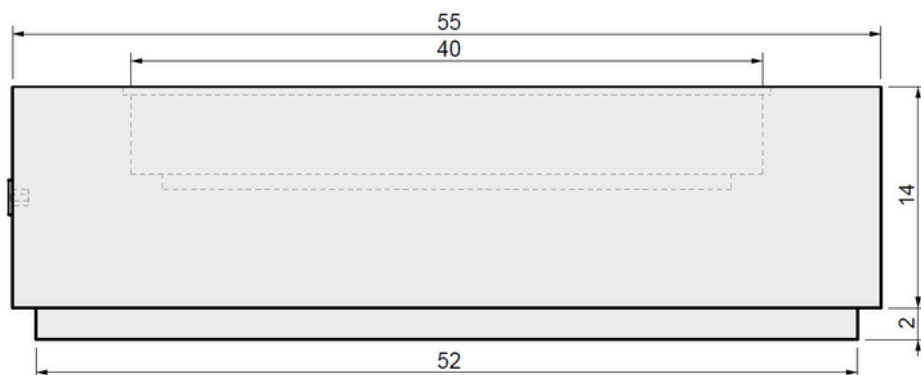

02 FRONT VIEW

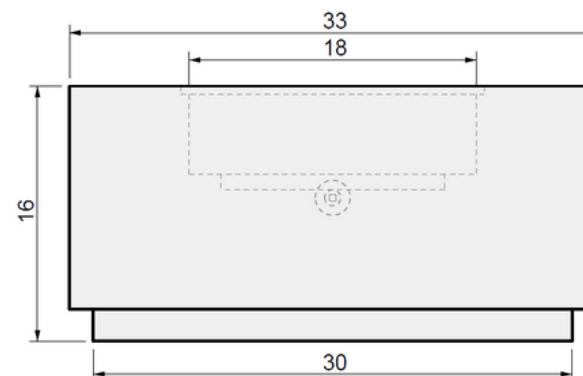

03 SIDE VIEW



**CONFIDENTIAL**

Any information data and drawings embodied in this document are proprietary and strictly confidential, are to be held as confidential and supplied with the understanding that they will not be disclosed, in whole or in part or in any form, to third parties without the prior written consent of Montana Fire Pits. All information, illustrations, screen shots, and data contained are herein Copyright © Montana Fire Pits. All rights reserved.

**Model:** Lumera Fire Table

**Size:** 55" L x 33" W x 16" H

**Material:** GFRC

**Burner:** CFBL150 - 150K BTU Linear Burner

**Fuel Pressure:** Natural Gas: 7" Water Column  
Propane: 11" Water Column

**Weight:** 250 lbs.

## Burner Detail

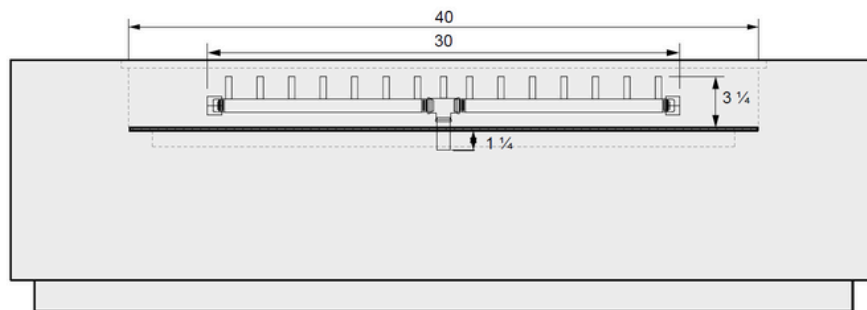

### BURNER SPECS

**LINEAR CFBL150**  
Dimensions: 30" x 1"  
150,000 BTU

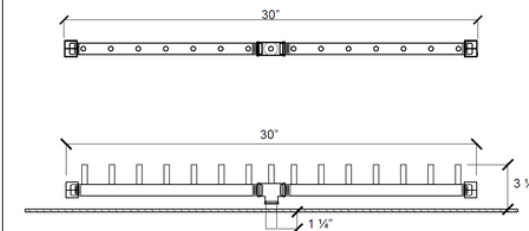

01 SIDE VIEW

## Plate Detail

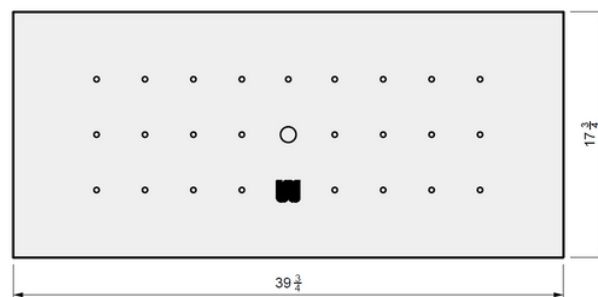

01 TOP VIEW

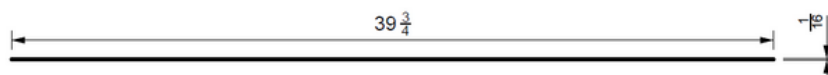

02 FRONT VIEW

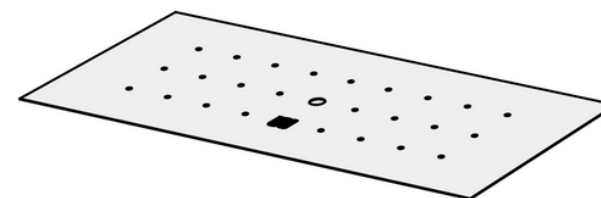

04 PERSPECTIVE

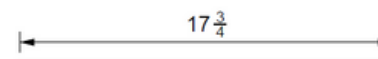

03 SIDE VIEW



### CONFIDENTIAL

Any information data and drawings embodied in this document are proprietary and strictly confidential, are to be held as confidential and supplied with the understanding that they will not be disclosed, in whole or in part or in any form, to third parties without the prior written consent of Montana Fire Pits. All information, illustrations, screen shots, and data contained are herein Copyright © Montana Fire Pits. All rights reserved.

**Model:** Lumera Fire Table

**Size:** 55" L x 33" W x 16" H

**Material:** GFRC

**Burner:** CFBL150 - 150K BTU Linear Burner

**Fuel Pressure:** Natural Gas: 7" Water Column  
Propane: 11" Water Column

**Weight:** 250 lbs.



01 TOP VIEW

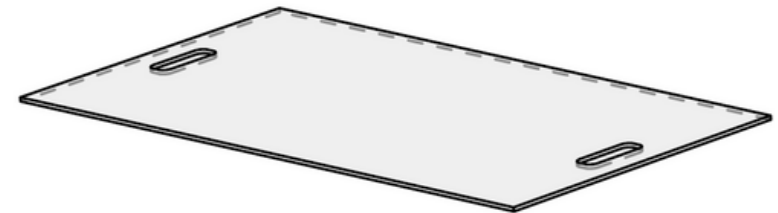

04 PERSPECTIVE

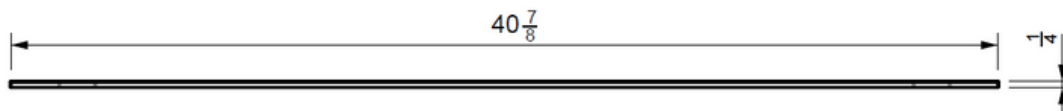

02 FRONT VIEW

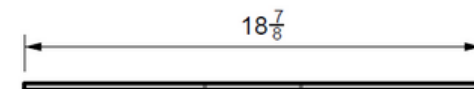

03 SIDE VIEW



**CONFIDENTIAL**

Any information data and drawings embodied in this document are proprietary and strictly confidential, are to be held as confidential and supplied with the understanding that they will not be disclosed, in whole or in part or in any form, to third parties without the prior written consent of Montana Fire Pits. All information, illustrations, screen shots, and data contained are herein Copyright © Montana Fire Pits. All rights reserved.

**Model:** Cover For 55" x 33" Lumera Fire Table Fire Table

**Material:** Powder Coated Aluminum

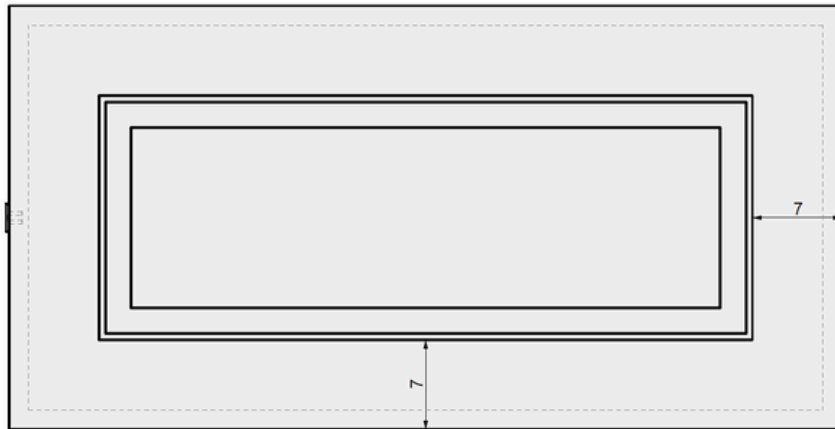

01 TOP VIEW

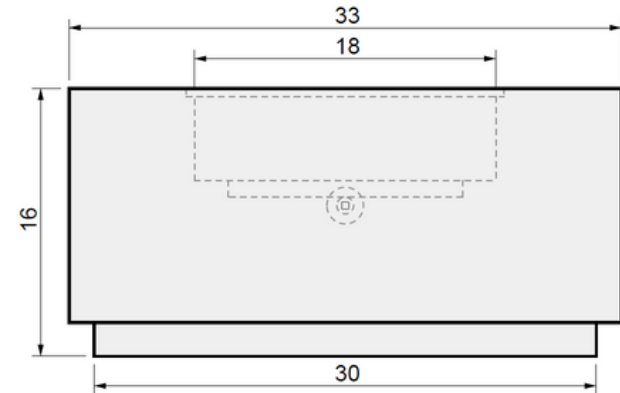

03 SIDE VIEW

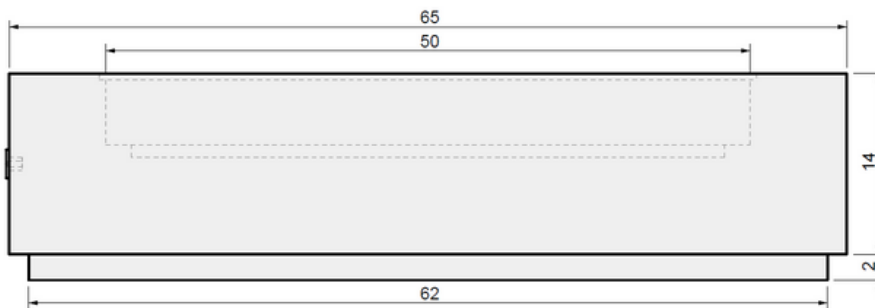

02 FRONT VIEW

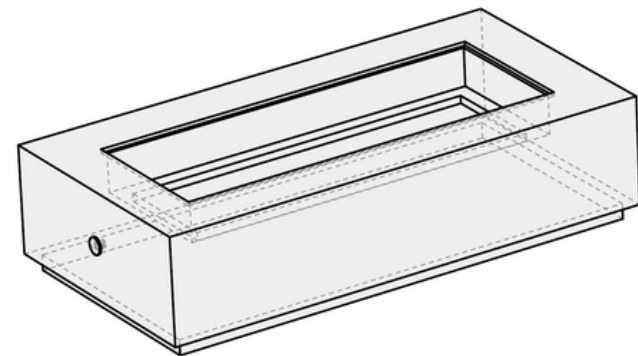

04 PERSPECTIVE



**CONFIDENTIAL**

Any information data and drawings embodied in this document are proprietary and strictly confidential, are to be held as confidential and supplied with the understanding that they will not be disclosed, in whole or in part or in any form, to third parties without the prior written consent of Montana Fire Pits. All information, illustrations, screen shots, and data contained are herein Copyright © Montana Fire Pits. All rights reserved.

**Model:** Lumera Fire Table

**Size:** 65" L x 33" W x 16" H

**Material:** GFRC

**Burner:** CFBL210 - 210K BTU Linear Burner

**Fuel Pressure:** Natural Gas: 7" Water Column  
Propane: 11" Water Column

**Weight:** 400 lbs.

## Burner Detail

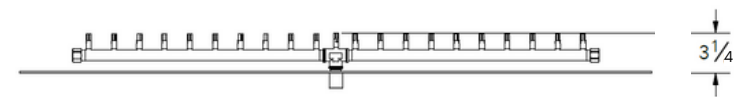
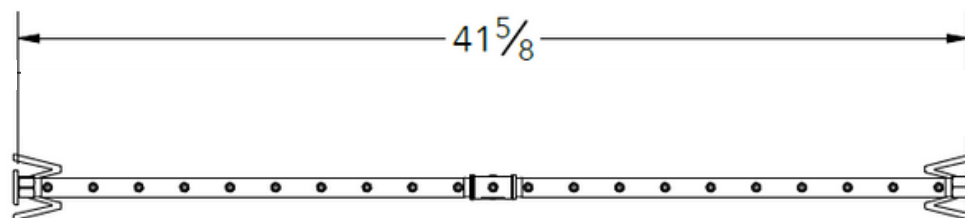

## Plate Detail

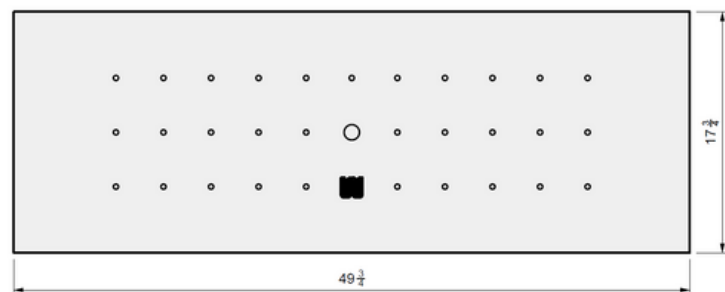

01 TOP VIEW

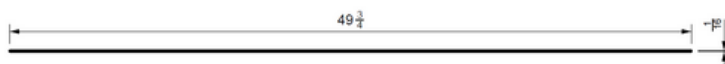

02 FRONT VIEW

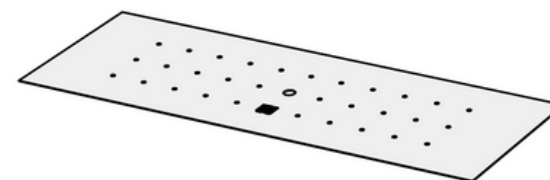

04 PERSPECTIVE



03 SIDE VIEW



### CONFIDENTIAL

Any information data and drawings embodied in this document are proprietary and strictly confidential, are to be held as confidential and supplied with the understanding that they will not be disclosed, in whole or in part or in any form, to third parties without the prior written consent of Montana Fire Pits. All information, illustrations, screen shots, and data contained are herein Copyright © Montana Fire Pits. All rights reserved.

**Model:** Lumera Fire Table

**Size:** 65" L x 33" W x 16" H

**Material:** GFRC

**Burner:** CFBL210 - 210K BTU Linear Burner

**Fuel Pressure:** Natural Gas: 7" Water Column  
Propane: 11" Water Column

**Weight:** 400 lbs.



01 TOP VIEW

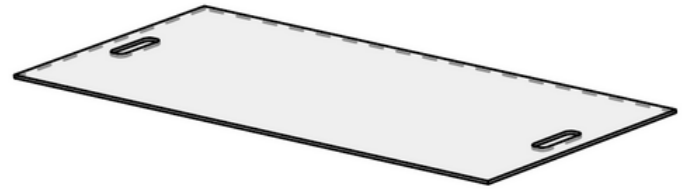

04 PERSPECTIVE

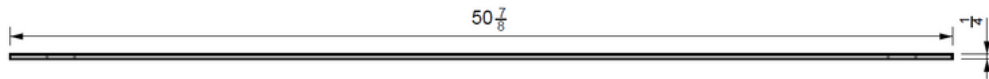

02 FRONT VIEW

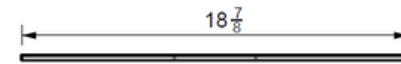

03 SIDE VIEW



**CONFIDENTIAL**

Any information data and drawings embodied in this document are proprietary and strictly confidential, are to be held as confidential and supplied with the understanding that they will not be disclosed, in whole or in part or in any form, to third parties without the prior written consent of Montana Fire Pits. All information, illustrations, screen shots, and data contained are herein Copyright © Montana Fire Pits. All rights reserved.

**Model:** Cover For 65" x 33" Lumera Fire Table Fire Table

**Material:** Powder Coated Aluminum

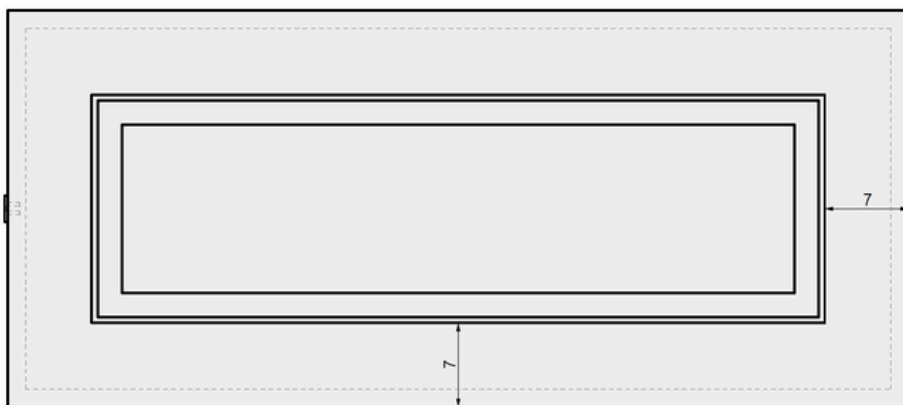

01 TOP VIEW

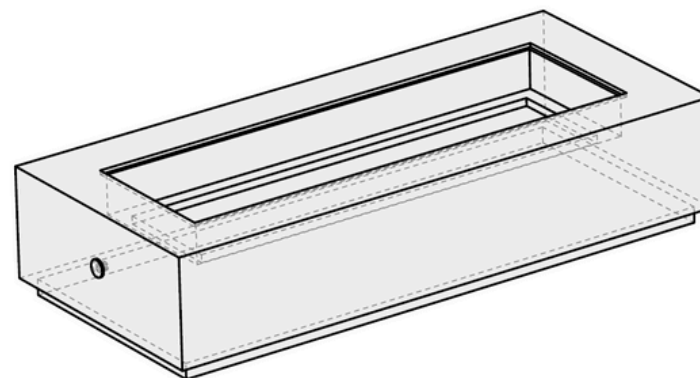

04 PERSPECTIVE

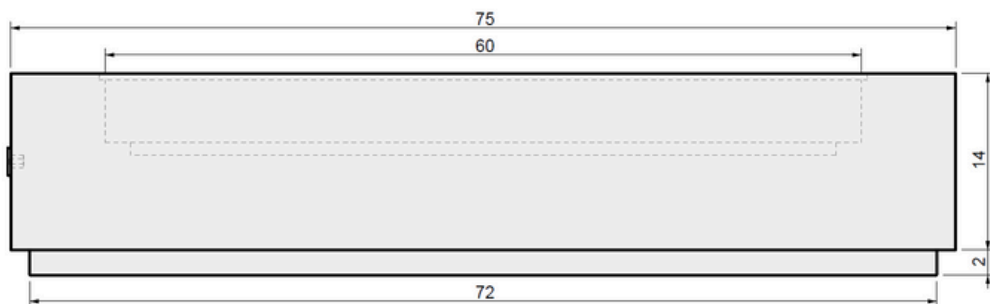

02 FRONT VIEW

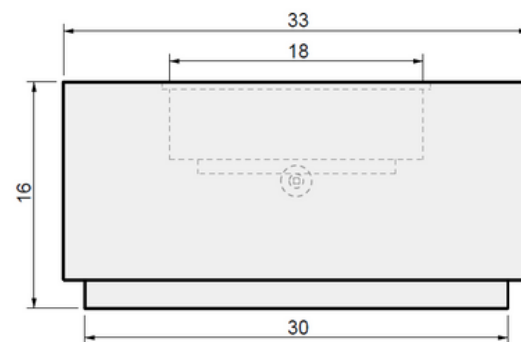

03 SIDE VIEW



**CONFIDENTIAL**

Any information data and drawings embodied in this document are proprietary and strictly confidential, are to be held as confidential and supplied with the understanding that they will not be disclosed, in whole or in part or in any form, to third parties without the prior written consent of Montana Fire Pits. All information, illustrations, screen shots, and data contained are herein Copyright © Montana Fire Pits. All rights reserved.

**Model:** Lumera Fire Table

**Size:** 75" L x 33" W x 16" H

**Material:** GFRC

**Burner:** CFBL250 - 250K BTU Linear Burner

**Fuel Pressure:** Natural Gas: 7" Water Column  
Propane: 11" Water Column

**Weight:** 450 lbs.

## Burner Detail

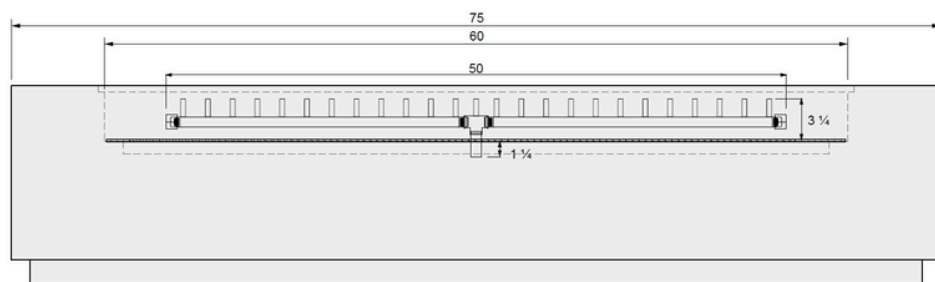

01 SIDE VIEW

### BURNER MODEL

**LINEAR CFBL250**  
Dimensions: 50" x 1"  
250,000 BTU

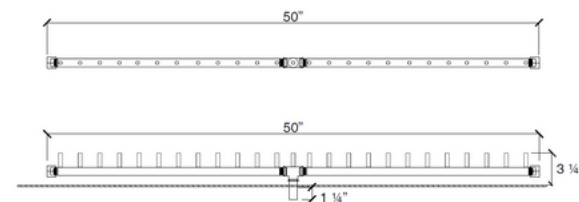

## Plate Detail

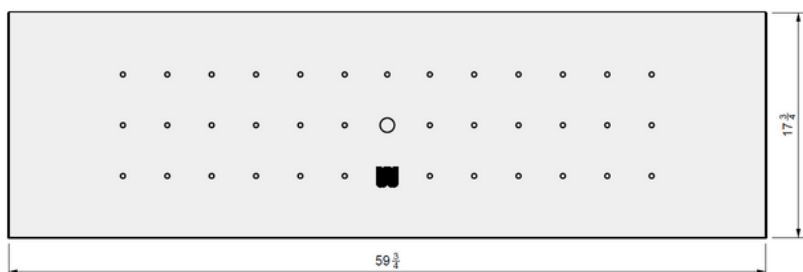

01 TOP VIEW

02 FRONT VIEW

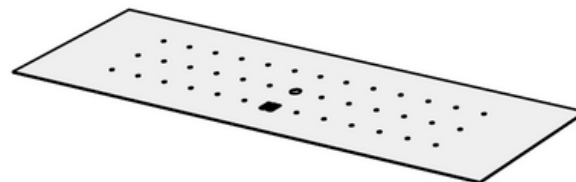

04 PERSPECTIVE

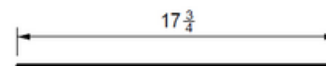

03 SIDE VIEW



### CONFIDENTIAL

Any information data and drawings embodied in this document are proprietary and strictly confidential, are to be held as confidential and supplied with the understanding that they will not be disclosed, in whole or in part or in any form, to third parties without the prior written consent of Montana Fire Pits. All information, illustrations, screen shots, and data contained are herein Copyright © Montana Fire Pits. All rights reserved.

**Model:** Lumera Fire Table

**Size:** 75" L x 33" W x 16" H

**Material:** GFRC

**Burner:** CFBL250 - 250K BTU Linear Burner

**Fuel Pressure:** Natural Gas: 7" Water Column  
Propane: 11" Water Column

**Weight:** 450 lbs.



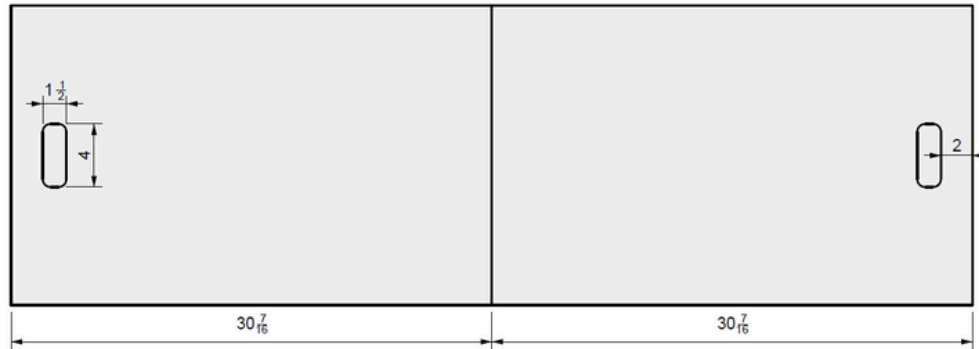

01 TOP VIEW

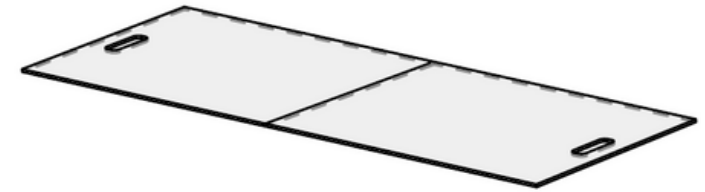

04 PERSPECTIVE

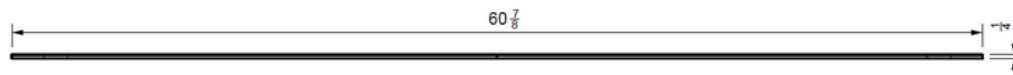

02 FRONT VIEW

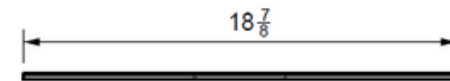

03 SIDE VIEW



**CONFIDENTIAL**

Any information data and drawings embodied in this document are proprietary and strictly confidential, are to be held as confidential and supplied with the understanding that they will not be disclosed, in whole or in part or in any form, to third parties without the prior written consent of Montana Fire Pits. All information, illustrations, screen shots, and data contained are herein Copyright © Montana Fire Pits. All rights reserved.

**Model:** Cover For 75" x 33" Lumera Fire Table Fire Table

**Material:** Powder Coated Aluminum

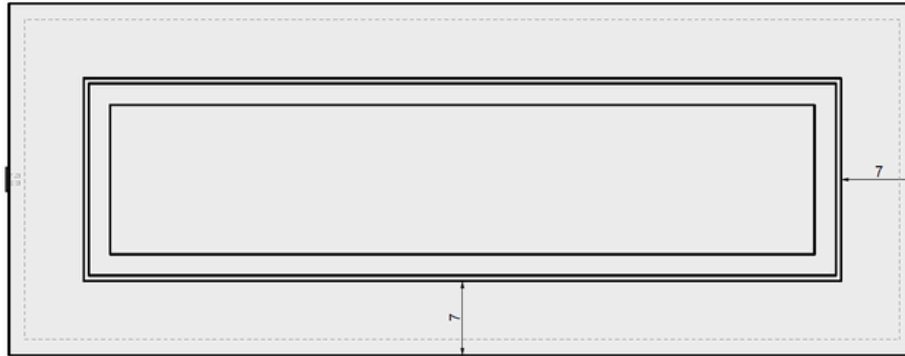

01 TOP VIEW

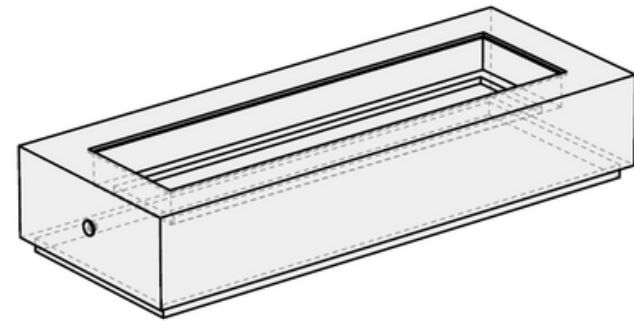

04 PERSPECTIVE

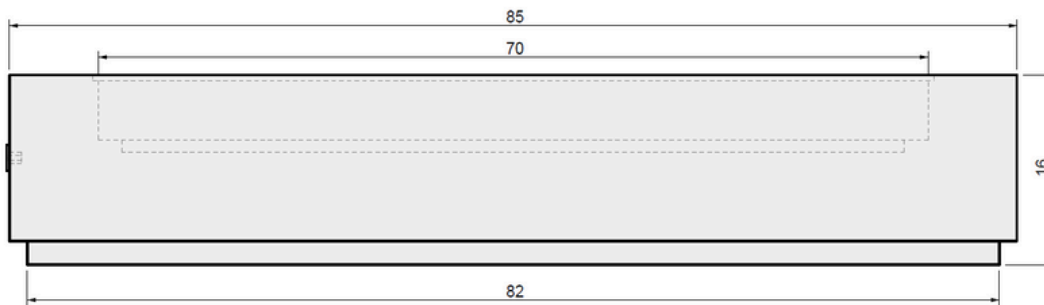

02 FRONT VIEW

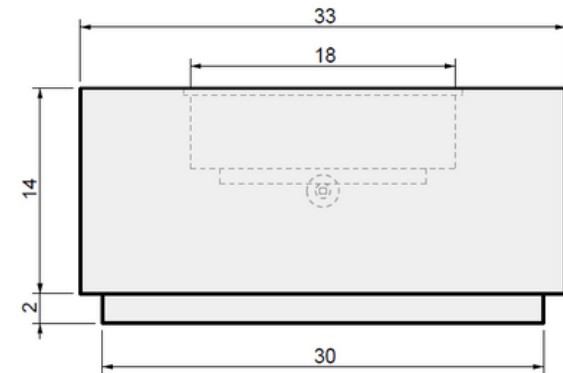

03 SIDE VIEW



**CONFIDENTIAL**

Any information data and drawings embodied in this document are proprietary and strictly confidential, are to be held as confidential and supplied with the understanding that they will not be disclosed, in whole or in part or in any form, to third parties without the prior written consent of Montana Fire Pits. All information, illustrations, screen shots, and data contained are herein Copyright © Montana Fire Pits. All rights reserved.

**Model:** Lumera Fire Table

**Size:** 85" L x 33" W x 16" H

**Material:** GFRC

**Burner:** CFBL270 – 270K BTU Linear Burner

**Fuel Pressure:** Natural Gas: 7" Water Column  
Propane: 11" Water Column

**Weight:** 500 lbs.

## Burner Detail

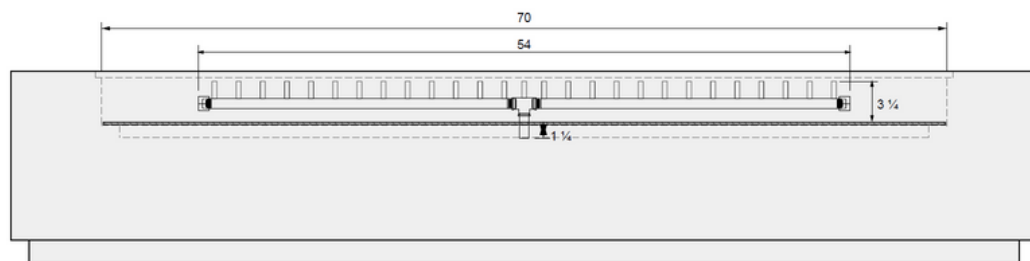

01 SIDE VIEW

## Plate Detail

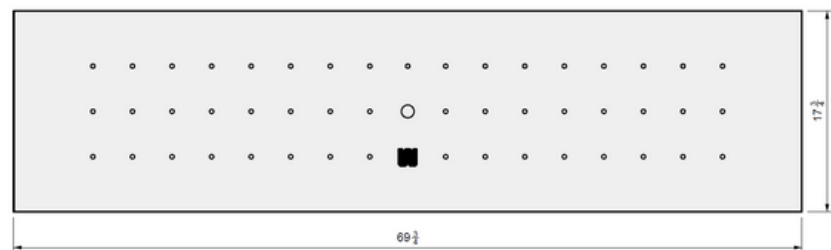

01 TOP VIEW

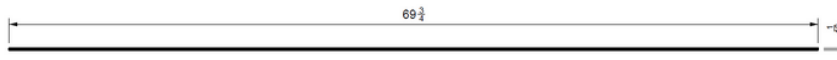

02 FRONT VIEW

## BURNER MODEL

**LINEAR CFBL270**  
Dimensions: 54" x 1"  
270,000 BTU

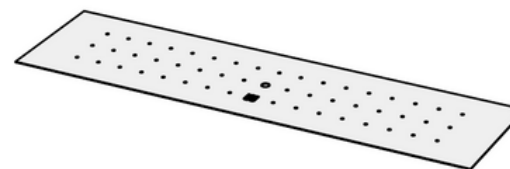
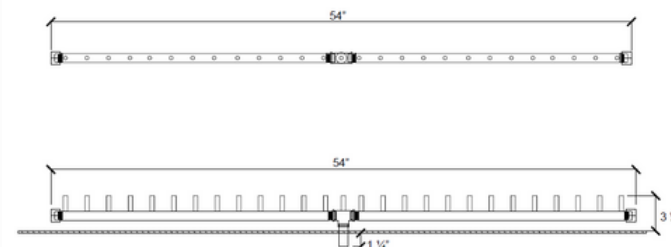

04 PERSPECTIVE



03 SIDE VIEW



### CONFIDENTIAL

Any information data and drawings embodied in this document are proprietary and strictly confidential, are to be held as confidential and supplied with the understanding that they will not be disclosed, in whole or in part or in any form, to third parties without the prior written consent of Montana Fire Pits. All information, illustrations, screen shots, and data contained are herein Copyright © Montana Fire Pits. All rights reserved.

**Model:** Lumera Fire Table

**Size:** 85" L x 33" W x 16" H

**Material:** GFRC

**Burner:** CFBL270 - 270K BTU Linear Burner

**Fuel Pressure:** Natural Gas: 7" Water Column  
Propane: 11" Water Column

**Weight:** 500 lbs.

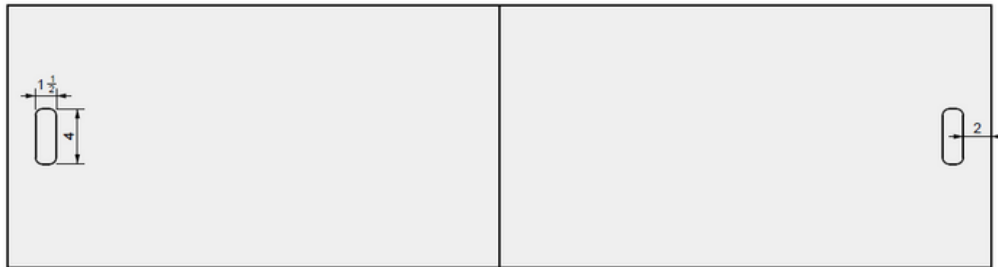

01 TOP VIEW

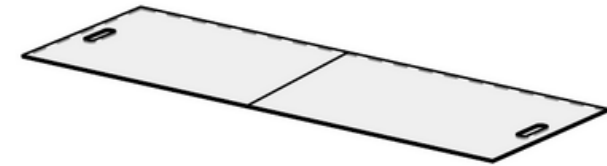

04 PERSPECTIVE

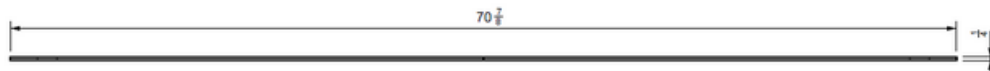

02 FRONT VIEW

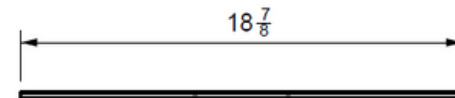

03 SIDE VIEW



**CONFIDENTIAL**

Any information data and drawings embodied in this document are proprietary and strictly confidential, are to be held as confidential and supplied with the understanding that they will not be disclosed, in whole or in part or in any form, to third parties without the prior written consent of Montana Fire Pits. All information, illustrations, screen shots, and data contained are herein Copyright © Montana Fire Pits. All rights reserved.

**Model:** Cover For 85" x 33" Lumera Fire Table Fire Table

**Material:** Powder Coated Aluminum

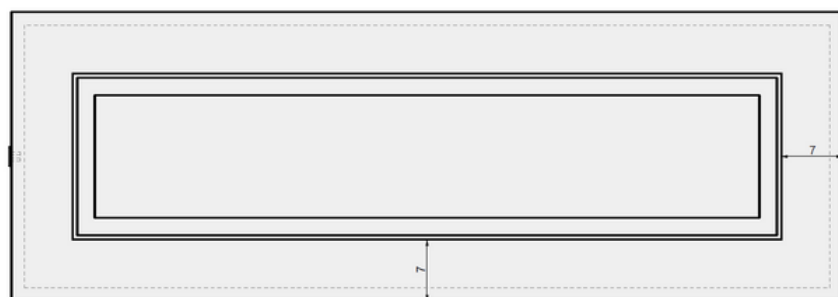

01 TOP VIEW

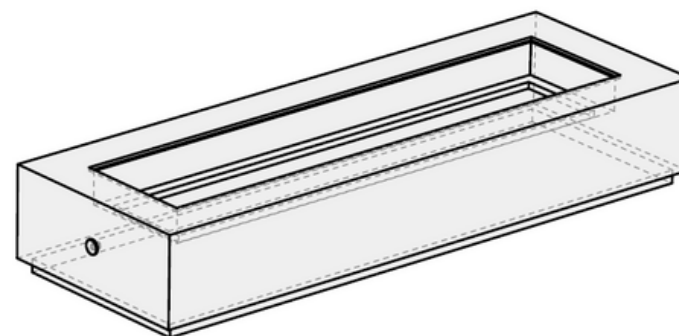

04 PERSPECTIVE

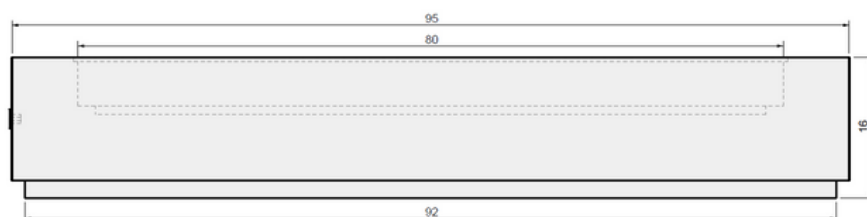

02 FRONT VIEW

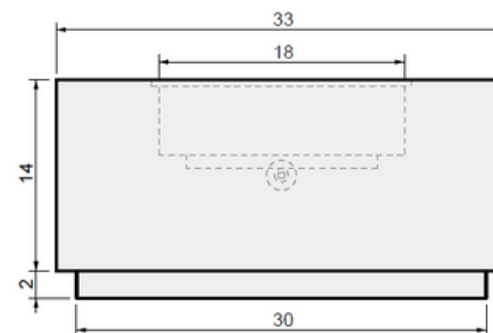

03 SIDE VIEW



**CONFIDENTIAL**

Any information data and drawings embodied in this document are proprietary and strictly confidential, are to be held as confidential and supplied with the understanding that they will not be disclosed, in whole or in part or in any form, to third parties without the prior written consent of Montana Fire Pits. All information, illustrations, screen shots, and data contained are herein Copyright © Montana Fire Pits. All rights reserved.

**Model:** Lumera Fire Table

**Size:** 95" L x 33" W x 16" H

**Material:** GFRC

**Burner:** CFBL310 – 310K BTU Linear Burner

**Fuel Pressure:** Natural Gas: 7" Water Column  
Propane: 11" Water Column

**Weight:** 575 lbs.

## Plate Detail

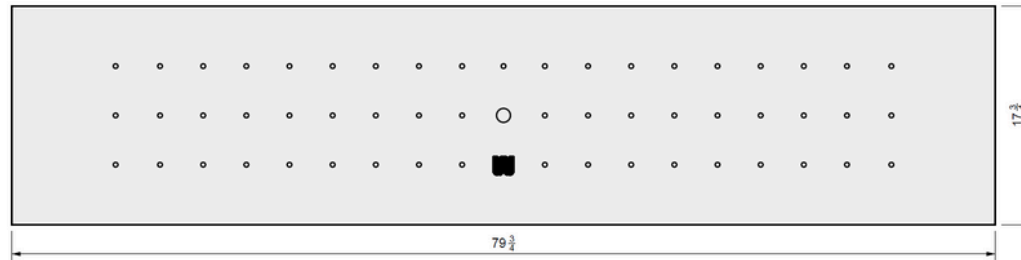

01 TOP VIEW

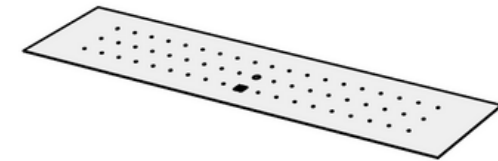

04 PERSPECTIVE

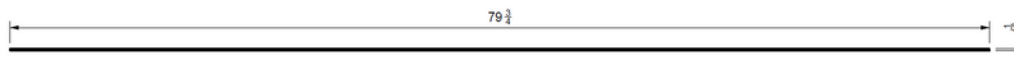

02 FRONT VIEW

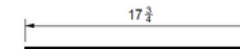

03 SIDE VIEW



### CONFIDENTIAL

Any information data and drawings embodied in this document are proprietary and strictly confidential, are to be held as confidential and supplied with the understanding that they will not be disclosed, in whole or in part or in any form, to third parties without the prior written consent of Montana Fire Pits. All information, illustrations, screen shots, and data contained are herein Copyright © Montana Fire Pits. All rights reserved.

**Model:** Lumera Fire Table

**Size:** 95" L x 33" W x 16" H

**Material:** GFRC

**Burner:** CFBL310 – 310K BTU Linear Burner

**Fuel Pressure:** Natural Gas: 7" Water Column  
Propane: 11" Water Column

**Weight:** 575 lbs.



01 TOP VIEW

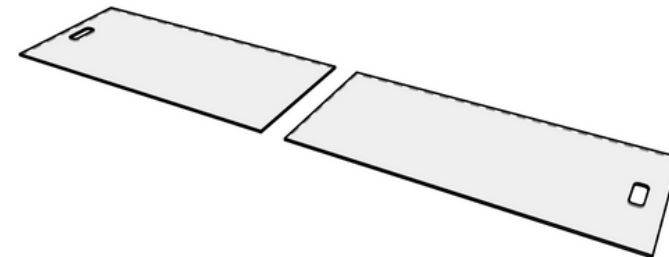

04 PERSPECTIVE

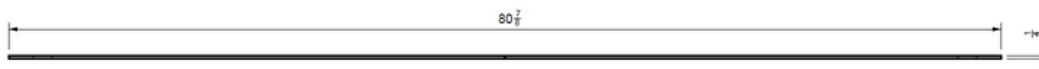

02 FRONT VIEW



03 SIDE VIEW



**CONFIDENTIAL**

Any information data and drawings embodied in this document are proprietary and strictly confidential, are to be held as confidential and supplied with the understanding that they will not be disclosed, in whole or in part or in any form, to third parties without the prior written consent of Montana Fire Pits. All information, illustrations, screen shots, and data contained are herein Copyright © Montana Fire Pits. All rights reserved.

**Model:** Cover For 95" x 33" Lumera Fire Table Fire Table

**Material:** Powder Coated Aluminum