

01 TOP VIEW

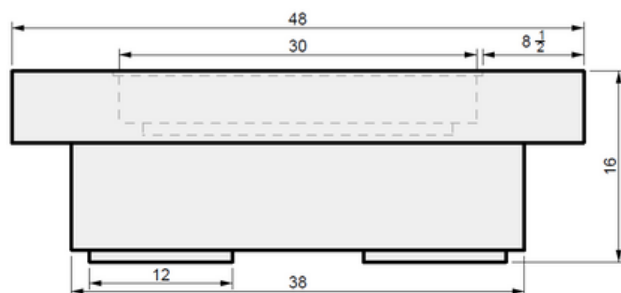

02 FRONT VIEW

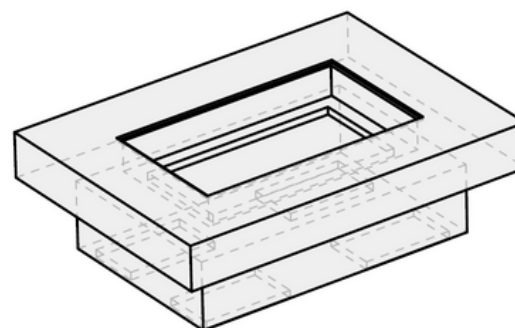

04 PERSPECTIVE

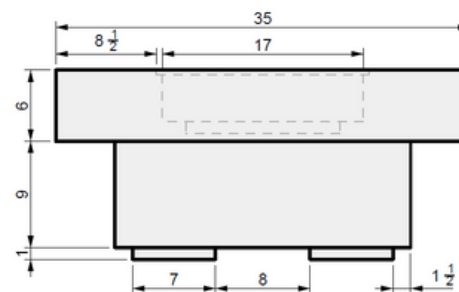

03 SIDE VIEW



CONFIDENTIAL

Any information data and drawings embodied in this document are proprietary and strictly confidential, are to be held as confidential and supplied with the understanding that they will not be disclosed, in whole or in part or in any form, to third parties without the prior written consent of Montana Fire Pits. All information, illustrations, screen shots, and data contained are herein Copyright © Montana Fire Pits. All rights reserved.

Model: Fortis Fire Table

Size: 48" L x 35" W x 16" H

Material: GFRC

Burner: CFBL130 - 130K BTU Linear Burner

Fuel Pressure: Natural Gas: 7" Water Column
Propane: 11" Water Column

Weight: Approx. 415 lbs.

Plate Detail

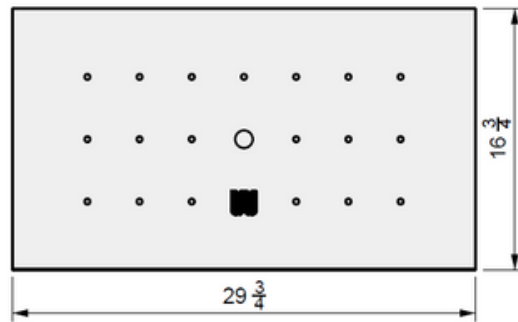

01 TOP VIEW



02 FRONT VIEW



03 SIDE VIEW

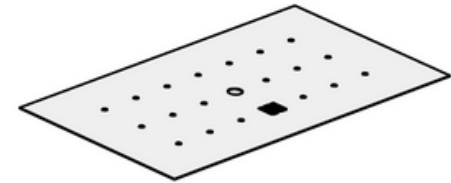

04 PERSPECTIVE

Cover Detail

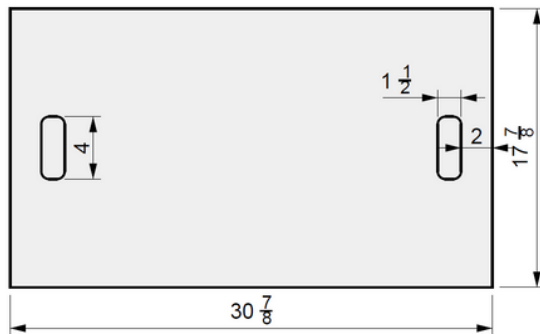

01 TOP VIEW

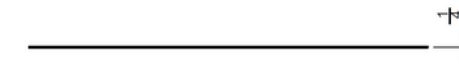

02 FRONT VIEW



03 SIDE VIEW

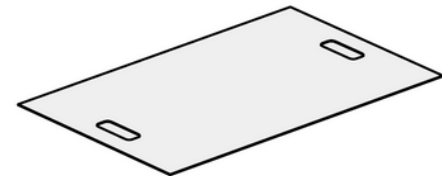

04 PERSPECTIVE



CONFIDENTIAL

Any information data and drawings embodied in this document are proprietary and strictly confidential, are to be held as confidential and supplied with the understanding that they will not be disclosed, in whole or in part or in any form, to third parties without the prior written consent of Montana Fire Pits. All information, illustrations, screen shots, and data contained are herein Copyright © Montana Fire Pits. All rights reserved.

Model: Fortis Fire Table

Size: 48" L x 35" W x 16" H

Material: GFRC

Burner: CFBL130 - 130K BTU Linear Burner

Fuel Pressure: Natural Gas: 7" Water Column
Propane: 11" Water Column

Weight: Approx. 415 lbs.

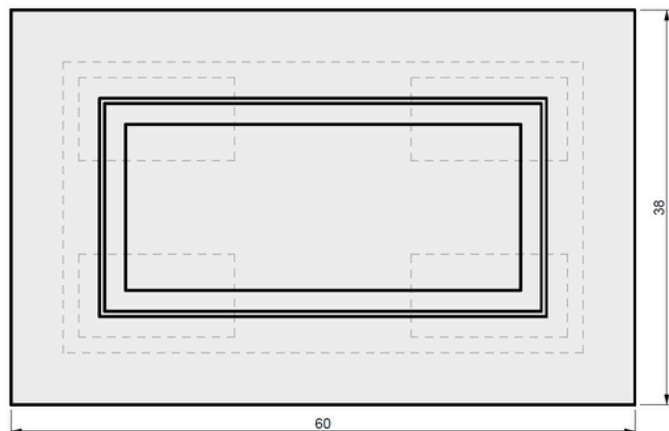

01 TOP VIEW

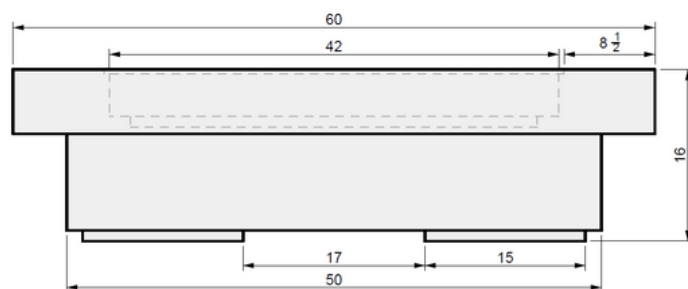

02 FRONT VIEW

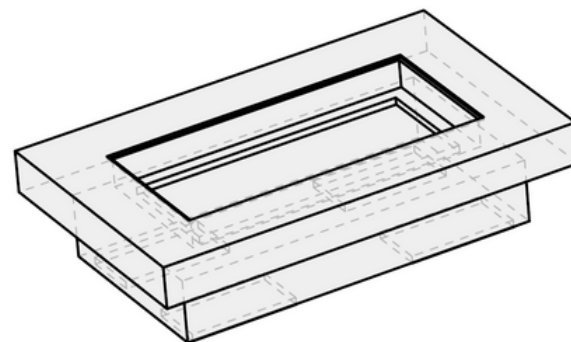

04 PERSPECTIVE

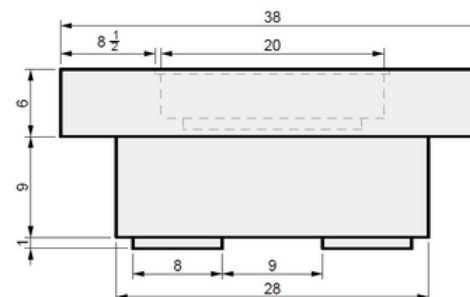

03 SIDE VIEW



CONFIDENTIAL

Any information data and drawings embodied in this document are proprietary and strictly confidential, are to be held as confidential and supplied with the understanding that they will not be disclosed, in whole or in part or in any form, to third parties without the prior written consent of Montana Fire Pits. All information, illustrations, screen shots, and data contained are herein Copyright © Montana Fire Pits. All rights reserved.

Model: Fortis Fire Table

Size: 60" L x 38" W x 16" H

Material: GFRC

Burner: CFBL170 - 170K BTU Linear Burner

Fuel Pressure: Natural Gas: 7" Water Column
Propane: 11" Water Column

Weight: Approx. 635 lbs.

Plate Detail

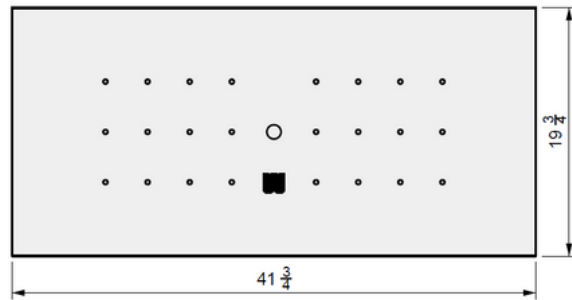

01 TOP VIEW



02 FRONT VIEW



03 SIDE VIEW

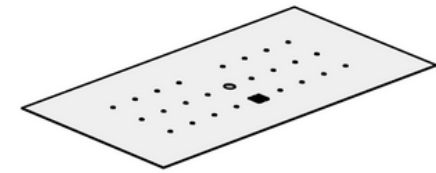

04 PERSPECTIVE

Cover Detail

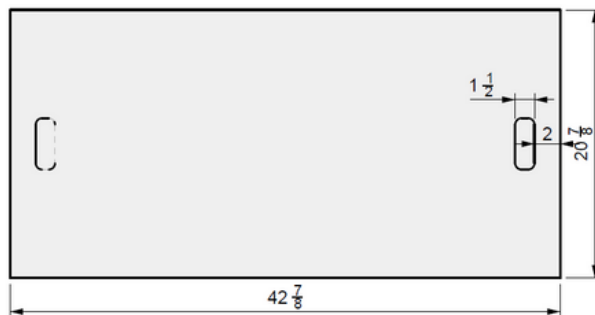

01 TOP VIEW



02 FRONT VIEW



03 SIDE VIEW

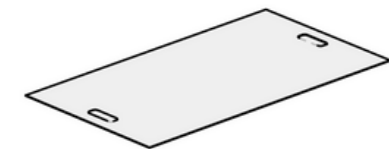

04 PERSPECTIVE



CONFIDENTIAL

Any information data and drawings embodied in this document are proprietary and strictly confidential, are to be held as confidential and supplied with the understanding that they will not be disclosed, in whole or in part or in any form, to third parties without the prior written consent of Montana Fire Pits. All information, illustrations, screen shots, and data contained are herein Copyright © Montana Fire Pits. All rights reserved.

Model: Fortis Fire Table

Size: 60" L x 38" W x 16" H

Material: GFRC

Burner: CFBL170 - 170K BTU Linear Burner

Fuel Pressure: Natural Gas: 7" Water Column
Propane: 11" Water Column

Weight: Approx. 635 lbs.

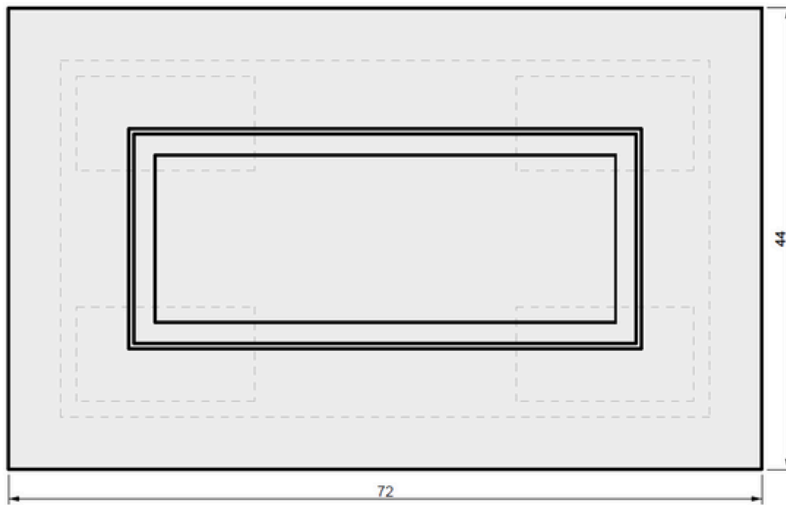

01 TOP VIEW

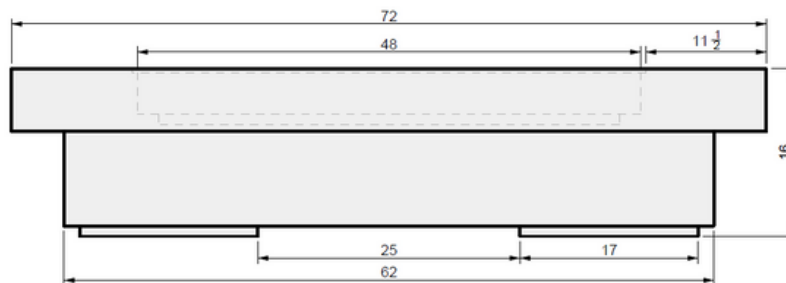

02 FRONT VIEW

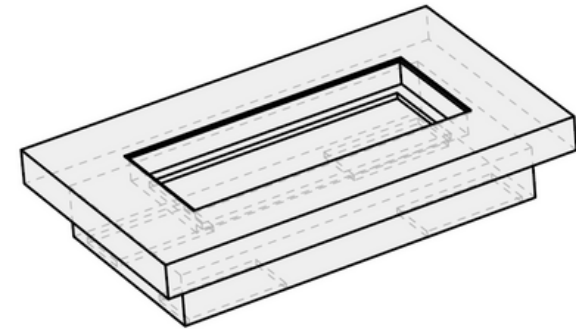

04 PERSPECTIVE

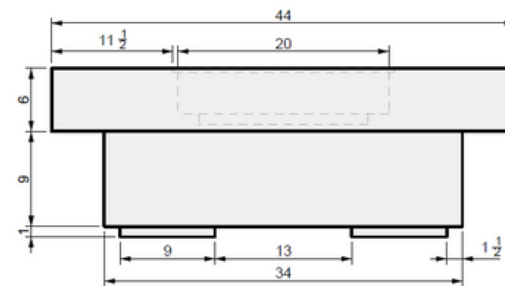

03 SIDE VIEW



CONFIDENTIAL

Any information data and drawings embodied in this document are proprietary and strictly confidential, are to be held as confidential and supplied with the understanding that they will not be disclosed, in whole or in part or in any form, to third parties without the prior written consent of Montana Fire Pits. All information, illustrations, screen shots, and data contained are herein Copyright © Montana Fire Pits. All rights reserved.

Model: Fortis Fire Table

Size: 72" L x 44" W x 16" H

Material: GFRC

Burner: CFBL190 - 190K BTU Linear Burner

Fuel Pressure: Natural Gas: 7" Water Column
Propane: 11" Water Column

Weight: Approx. 850 lbs.

Plate Detail

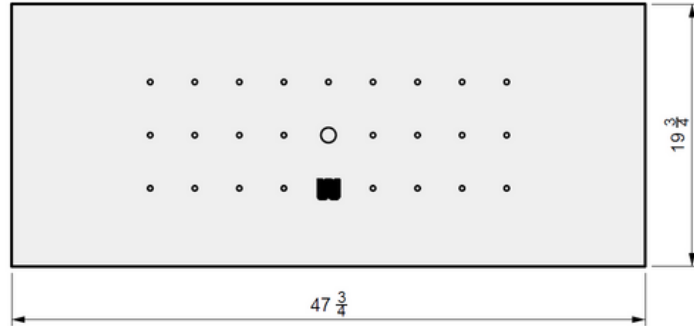

01 TOP VIEW



02 FRONT VIEW

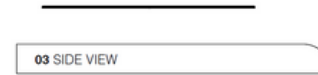

03 SIDE VIEW

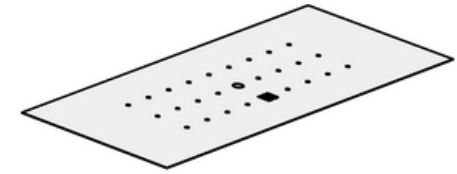

04 PERSPECTIVE

Cover Detail

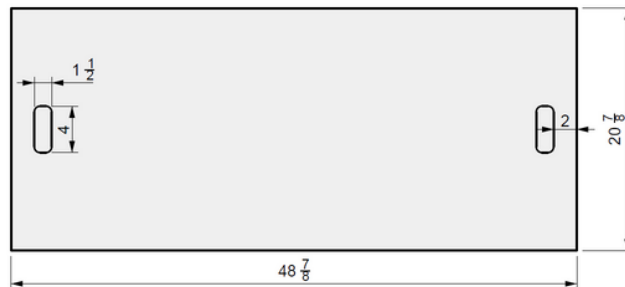

01 TOP VIEW



02 FRONT VIEW



03 SIDE VIEW

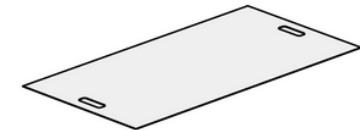

04 PERSPECTIVE



CONFIDENTIAL

Any information data and drawings embodied in this document are proprietary and strictly confidential, are to be held as confidential and supplied with the understanding that they will not be disclosed, in whole or in part or in any form, to third parties without the prior written consent of Montana Fire Pits. All information, illustrations, screen shots, and data contained are herein Copyright © Montana Fire Pits. All rights reserved.

Model: Fortis Fire Table

Size: 72" L x 44" W x 16" H

Material: GFRC

Burner: CFBL190 - 190K BTU Linear Burner

Fuel Pressure: Natural Gas: 7" Water Column
Propane: 11" Water Column

Weight: Approx. 850 lbs.

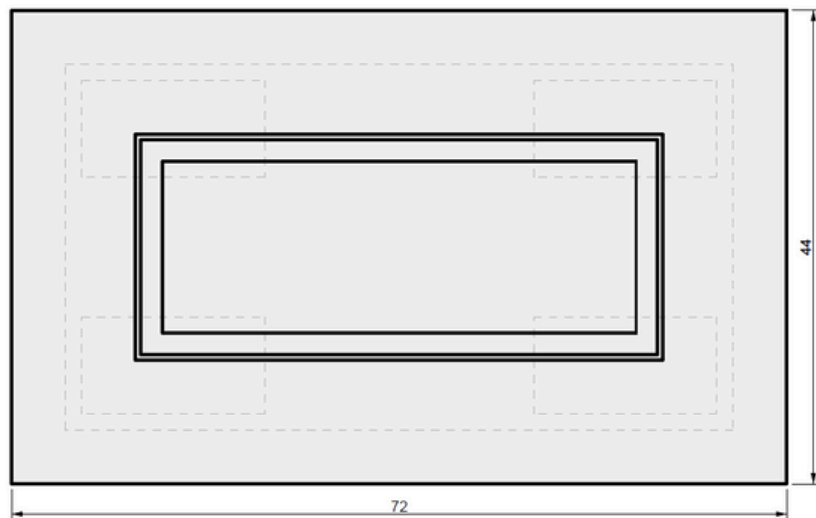

01 TOP VIEW

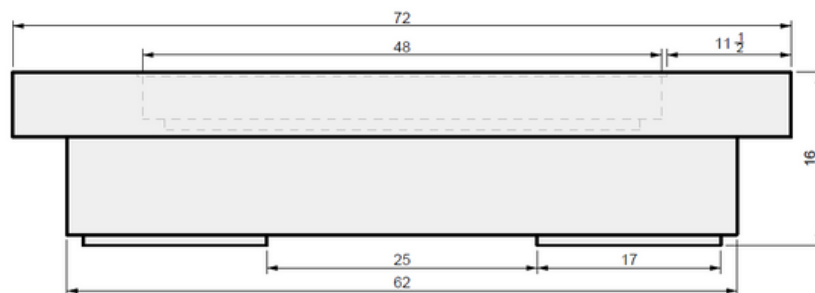

02 FRONT VIEW

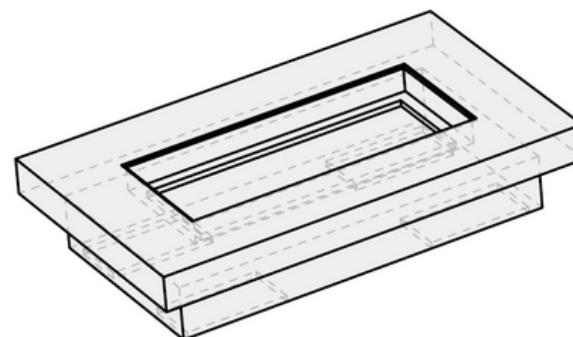

04 PERSPECTIVE

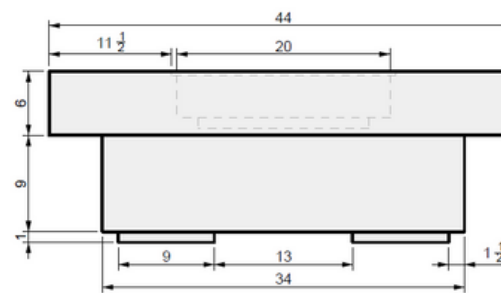

03 SIDE VIEW



CONFIDENTIAL

Any information data and drawings embodied in this document are proprietary and strictly confidential, are to be held as confidential and supplied with the understanding that they will not be disclosed, in whole or in part or in any form, to third parties without the prior written consent of Montana Fire Pits. All information, illustrations, screen shots, and data contained are herein Copyright © Montana Fire Pits. All rights reserved.

Model: Fortis Fire Table

Size: 84" L x 46" W x 16" H

Material: GFRC

Burner: CFBL190 - 190K BTU Linear Burner

Fuel Pressure: Natural Gas: 7" Water Column
Propane: 11" Water Column

Weight: Approx. 850 lbs.

Plate Detail

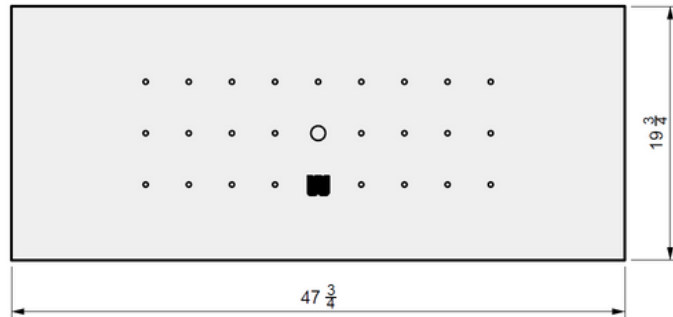

01 TOP VIEW



02 FRONT VIEW



03 SIDE VIEW

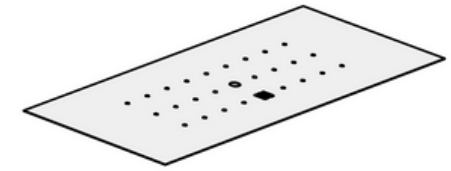

04 PERSPECTIVE

Cover Detail

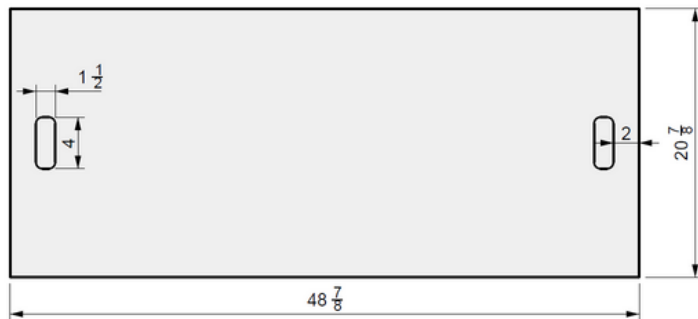

01 TOP VIEW



02 FRONT VIEW



03 SIDE VIEW

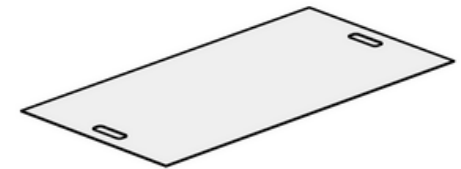

04 PERSPECTIVE



CONFIDENTIAL

Any information data and drawings embodied in this document are proprietary and strictly confidential, are to be held as confidential and supplied with the understanding that they will not be disclosed, in whole or in part or in any form, to third parties without the prior written consent of Montana Fire Pits. All information, illustrations, screen shots, and data contained are herein Copyright © Montana Fire Pits. All rights reserved.

Model: Fortis Fire Table

Size: 84" L x 46" W x 16" H

Material: GFRC

Burner: CFBL190 - 190K BTU Linear Burner

Fuel Pressure: Natural Gas: 7" Water Column
Propane: 11" Water Column

Weight: Approx. 850 lbs.

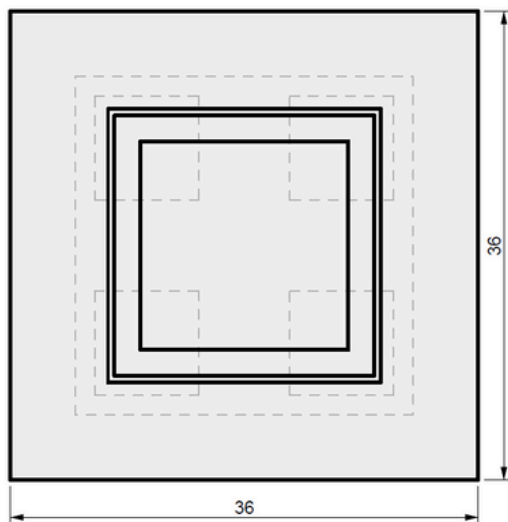

01 TOP VIEW

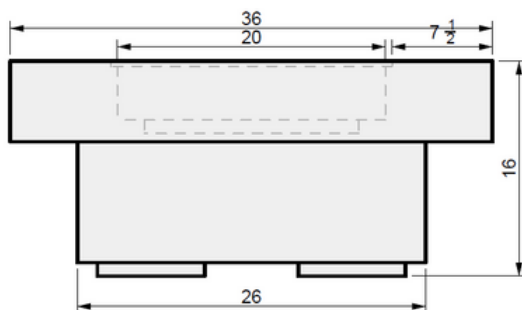

02 FRONT VIEW

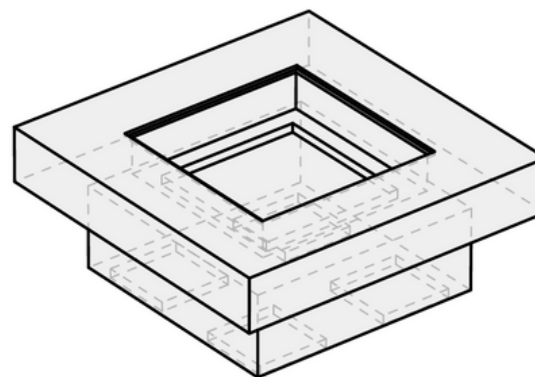

04 PERSPECTIVE

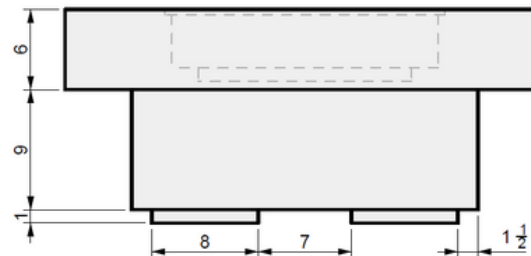

03 SIDE VIEW



CONFIDENTIAL

Any information data and drawings embodied in this document are proprietary and strictly confidential, are to be held as confidential and supplied with the understanding that they will not be disclosed, in whole or in part or in any form, to third parties without the prior written consent of Montana Fire Pits. All information, illustrations, screen shots, and data contained are herein Copyright © Montana Fire Pits. All rights reserved.

Model: Fortis Fire Table

Size: 36" L x 36" W x 16" H

Material: GFRC

Burner: CFB120 - 120K BTU Original Burner

Fuel Pressure: Natural Gas: 7" Water Column
Propane: 11" Water Column

Weight: Approx. 385 lbs.

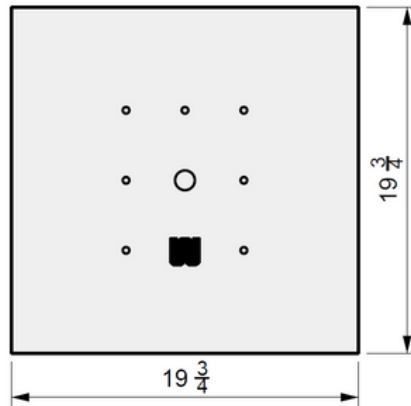

01 TOP VIEW

Plate Detail



02 FRONT VIEW

03 SIDE VIEW

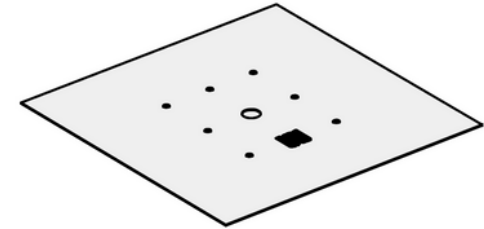

04 PERSPECTIVE

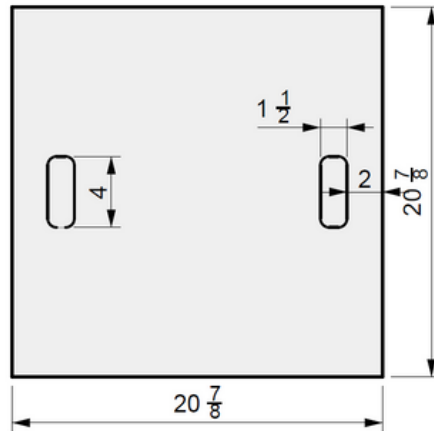

01 TOP VIEW

Cover Detail



02 FRONT VIEW

03 SIDE VIEW

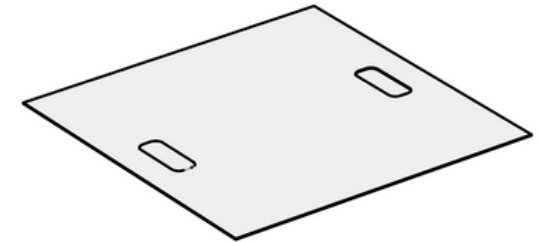

04 PERSPECTIVE



CONFIDENTIAL

Any information data and drawings embodied in this document are proprietary and strictly confidential, are to be held as confidential and supplied with the understanding that they will not be disclosed, in whole or in part or in any form, to third parties without the prior written consent of Montana Fire Pits. All information, illustrations, screen shots, and data contained are herein Copyright © Montana Fire Pits. All rights reserved.

Model: Fortis Fire Table

Size: 36" L x 36" W x 16" H

Material: GFRC

Burner: CFB120 - 120K BTU Original Burner

Fuel Pressure: Natural Gas: 7" Water Column
Propane: 11" Water Column

Weight: Approx. 385 lbs.

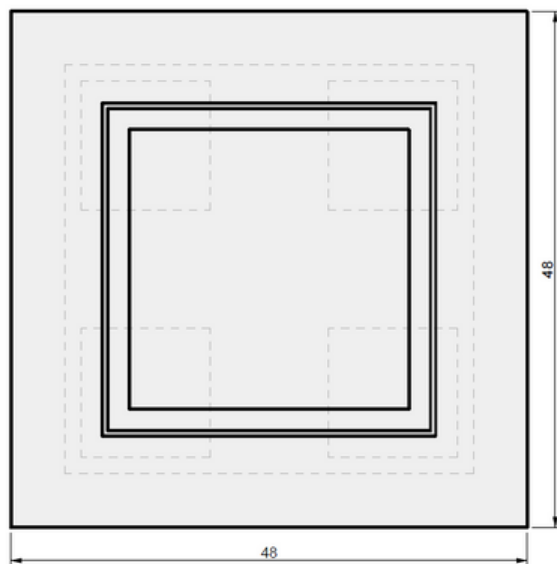

01 TOP VIEW

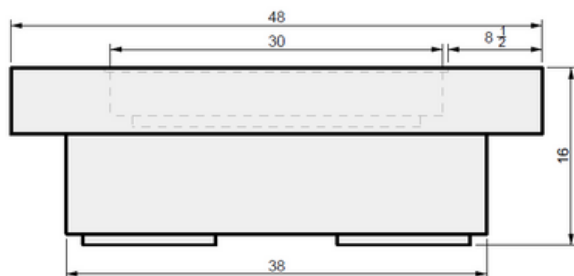

02 FRONT VIEW

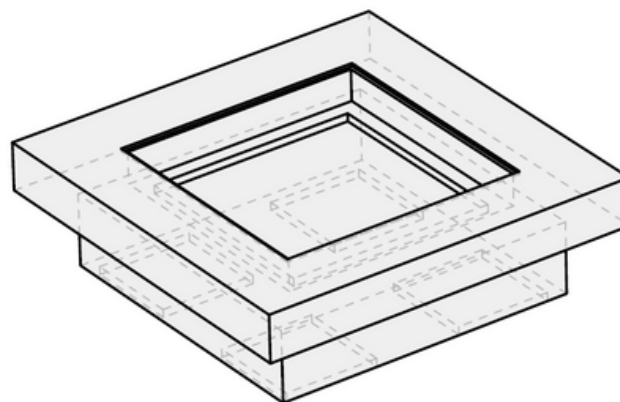

04 PERSPECTIVE

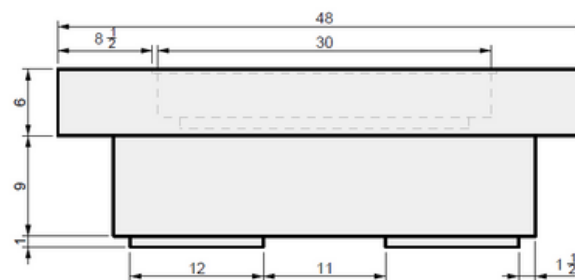

03 SIDE VIEW



CONFIDENTIAL

Any information data and drawings embodied in this document are proprietary and strictly confidential, are to be held as confidential and supplied with the understanding that they will not be disclosed, in whole or in part or in any form, to third parties without the prior written consent of Montana Fire Pits. All information, illustrations, screen shots, and data contained are herein Copyright © Montana Fire Pits. All rights reserved.

Model: Fortis Fire Table

Size: 48" L x 48" W x 16" H

Material: GFRC

Burner: CFB180 - 180K BTU Original Burner

Fuel Pressure: Natural Gas: 7" Water Column
Propane: 11" Water Column

Weight: Approx. 565 lbs.

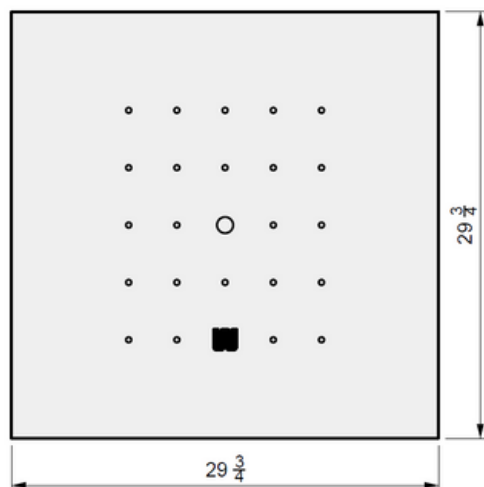

01 TOP VIEW

Plate Detail

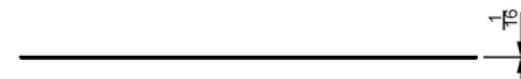

02 FRONT VIEW



03 SIDE VIEW

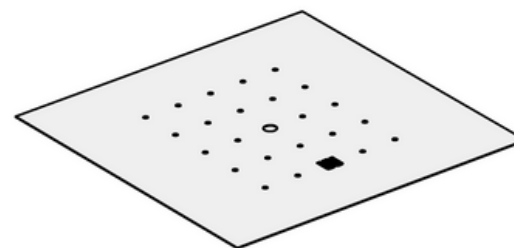

04 PERSPECTIVE

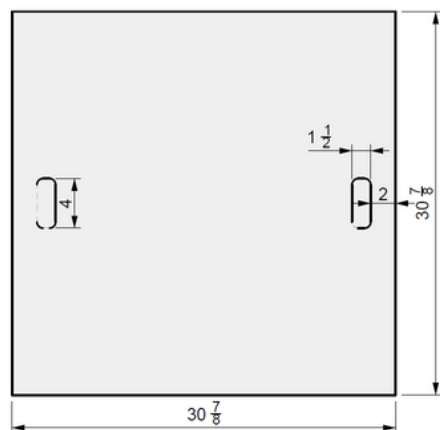

01 TOP VIEW

Cover Detail

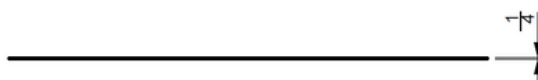

02 FRONT VIEW



03 SIDE VIEW

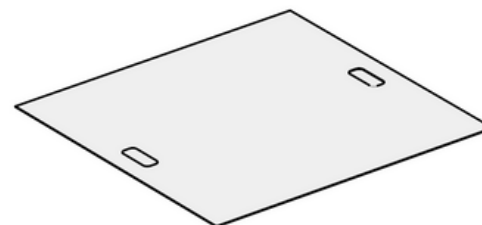

04 PERSPECTIVE



CONFIDENTIAL

Any information data and drawings embodied in this document are proprietary and strictly confidential, are to be held as confidential and supplied with the understanding that they will not be disclosed, in whole or in part or in any form, to third parties without the prior written consent of Montana Fire Pits. All information, illustrations, screen shots, and data contained are herein Copyright © Montana Fire Pits. All rights reserved.

Model: Fortis Fire Table

Size: 48" L x 48" W x 16" H

Material: GFRC

Burner: CFB180 - 180K BTU Original Burner

Fuel Pressure: Natural Gas: 7" Water Column
Propane: 11" Water Column

Weight: Approx. 565 lbs.

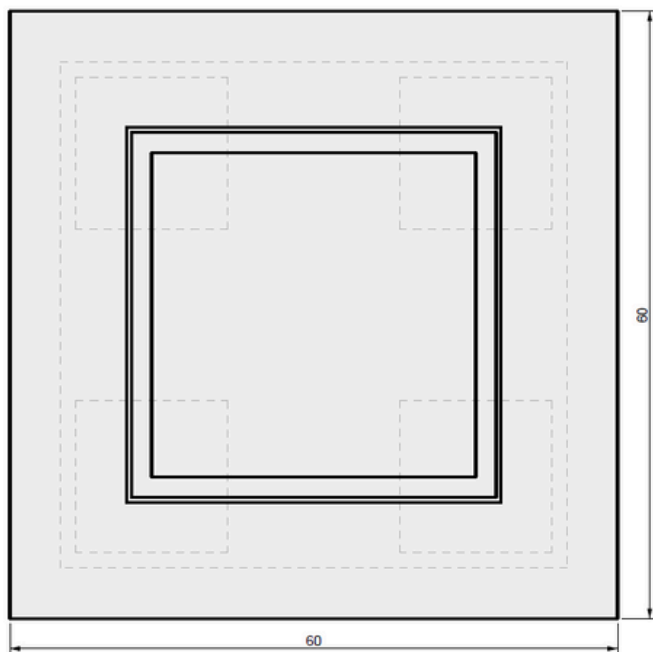

01 TOP VIEW

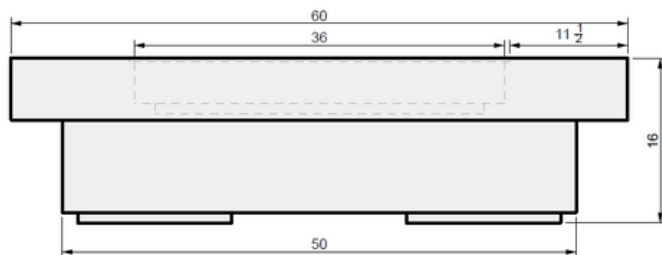

02 FRONT VIEW

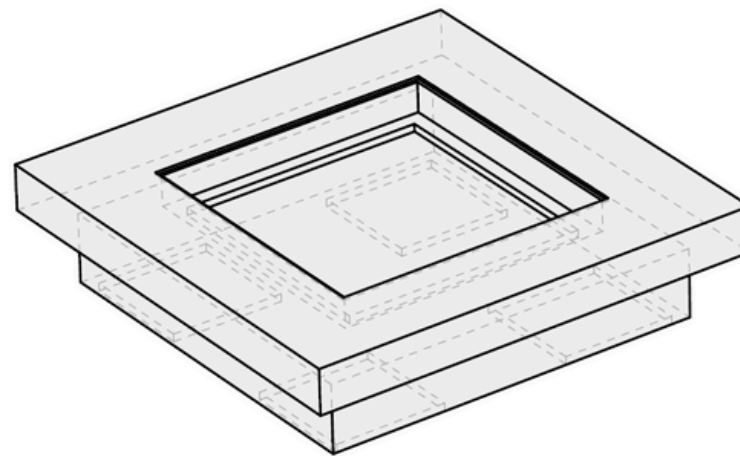

04 PERSPECTIVE

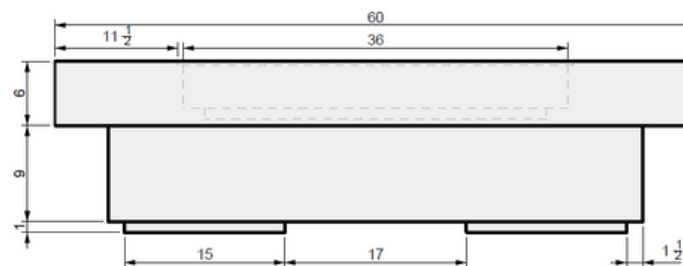

03 SIDE VIEW



CONFIDENTIAL

Any information data and drawings embodied in this document are proprietary and strictly confidential, are to be held as confidential and supplied with the understanding that they will not be disclosed, in whole or in part or in any form, to third parties without the prior written consent of Montana Fire Pits. All information, illustrations, screen shots, and data contained are herein Copyright © Montana Fire Pits. All rights reserved.

Model: Fortis Fire Table

Size: 60" L x 60" W x 16" H

Material: GFRC

Burner: CFB240 - 240K BTU Original Burner

Fuel Pressure: Natural Gas: 7" Water Column
Propane: 11" Water Column

Weight: Approx. 650 lbs.

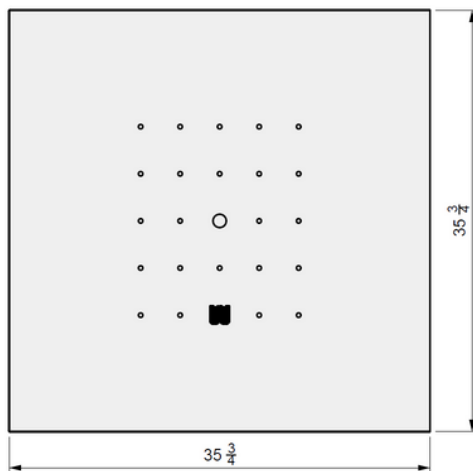

01 TOP VIEW

Plate Detail

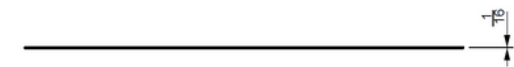

02 FRONT VIEW



03 SIDE VIEW

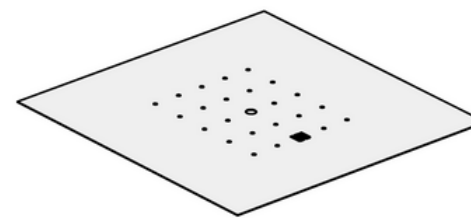

04 PERSPECTIVE

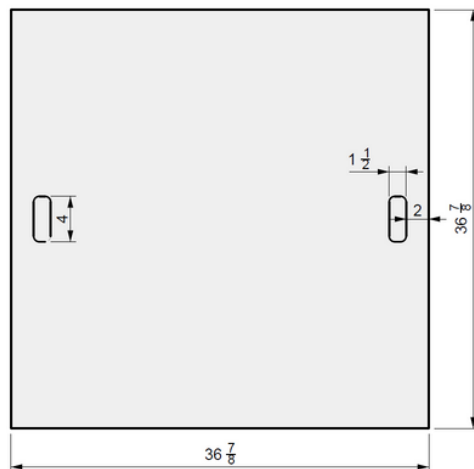

01 TOP VIEW

Cover Detail

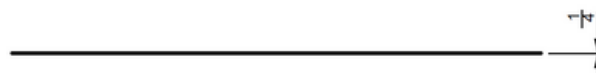

02 FRONT VIEW



03 SIDE VIEW

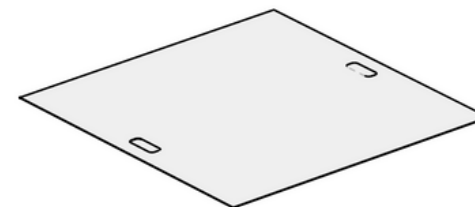

04 PERSPECTIVE



CONFIDENTIAL

Any information data and drawings embodied in this document are proprietary and strictly confidential, are to be held as confidential and supplied with the understanding that they will not be disclosed, in whole or in part or in any form, to third parties without the prior written consent of Montana Fire Pits. All information, illustrations, screen shots, and data contained are herein Copyright © Montana Fire Pits. All rights reserved.

Model: Fortis Fire Table

Size: 60" L x 60" W x 16" H

Material: GFRC

Burner: CFB240 - 240K BTU Original Burner

Fuel Pressure: Natural Gas: 7" Water Column
Propane: 11" Water Column

Weight: Approx. 650 lbs.