

01 TOP VIEW

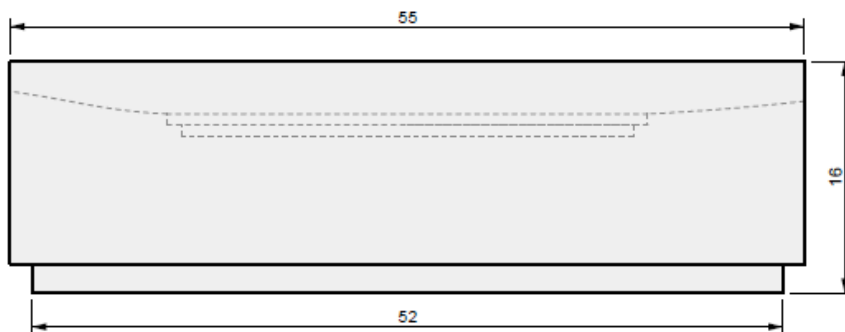

02 FRONT VIEW

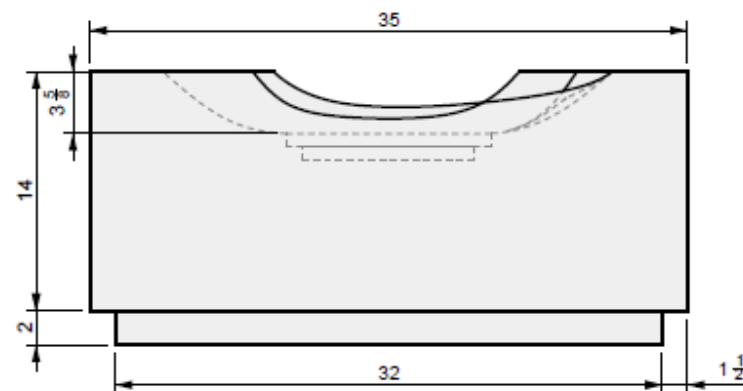

03 SIDE VIEW

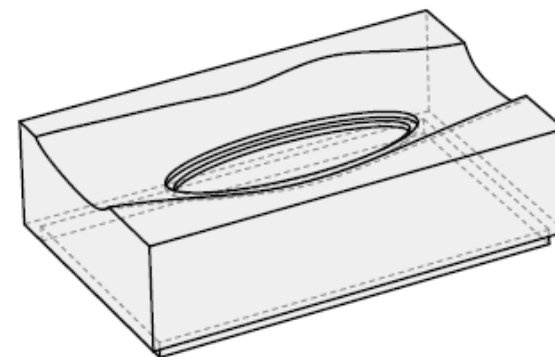

04 PERSPECTIVE



**CONFIDENTIAL**

Any information data and drawings embodied in this document are proprietary and strictly confidential, are to be held as confidential and supplied with the understanding that they will not be disclosed, in whole or in part or in any form, to third parties without the prior written consent of Montana Fire Pits. All information, illustrations, screen shots, and data contained are herein Copyright © Montana Fire Pits. All rights reserved.

**Model:** Canyon Fire Table

**Size:** 55" L x 35" W x 16" H

**Material:** GFRC

**Burner:** CFBL150 - 150K BTU Linear Burner

**Fuel Pressure:** Natural Gas: 7" Water Column  
Propane: 11" Water Column

**Vessel Weight:** 280 lbs.

## Burner Detail



### BURNER MODEL

LINEAR CFBL150  
Dimensions: 30" x 1"  
150,000 BTU

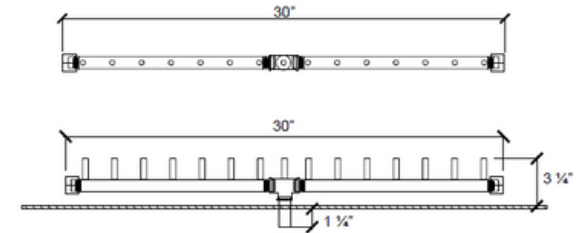

## Plate Detail

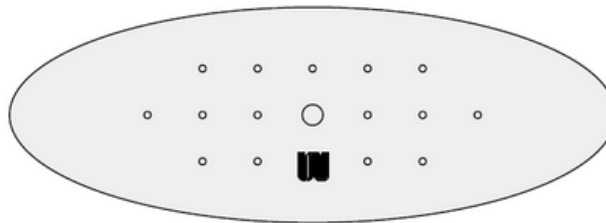

01 TOP VIEW

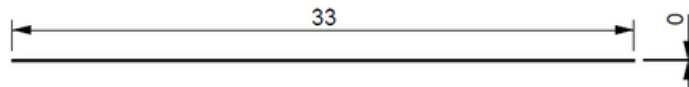

02 FRONT VIEW

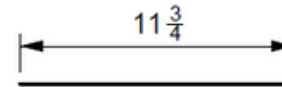

03 SIDE VIEW

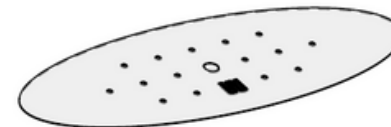

04 PERSPECTIVE



### CONFIDENTIAL

Any information data and drawings embodied in this document are proprietary and strictly confidential, are to be held as confidential and supplied with the understanding that they will not be disclosed, in whole or in part or in any form, to third parties without the prior written consent of Montana Fire Pits. All information, illustrations, screen shots, and data contained are herein Copyright © Montana Fire Pits. All rights reserved.

**Model:** Canyon Fire Table

**Size:** 55" L x 35" W x 16" H

**Material:** GFRC

**Burner:** CFBL150 - 150K BTU Linear Burner

**Fuel Pressure:** Natural Gas: 7" Water Column  
Propane: 11" Water Column

**Vessel Weight:** 280 lbs.

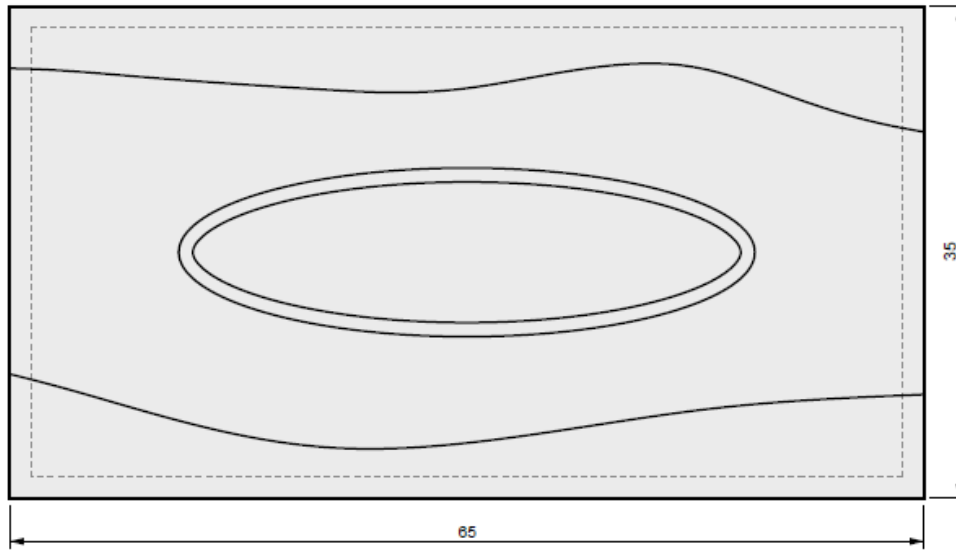

01 TOP VIEW

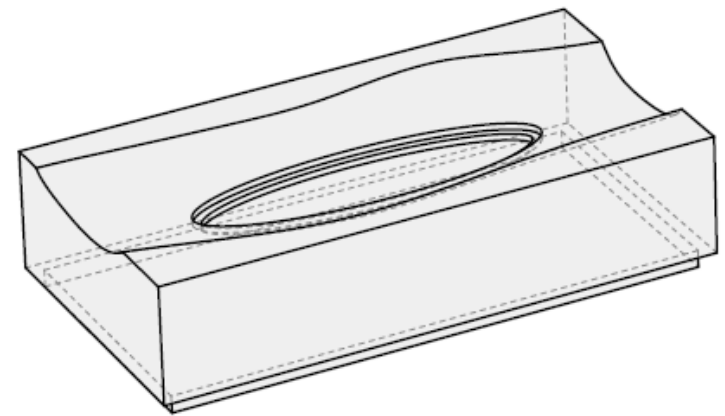

04 PERSPECTIVE

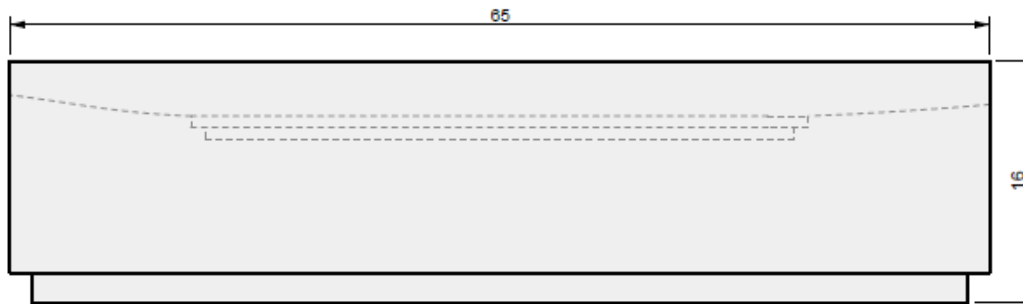

02 FRONT VIEW

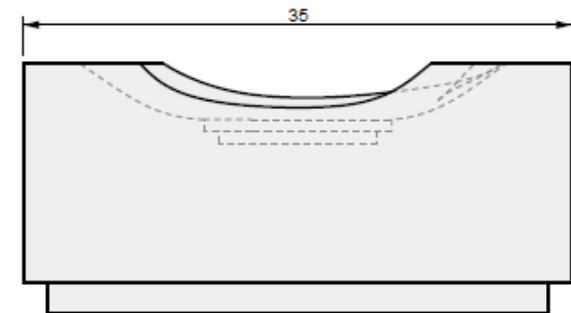

03 SIDE VIEW



**CONFIDENTIAL**

Any information data and drawings embodied in this document are proprietary and strictly confidential, are to be held as confidential and supplied with the understanding that they will not be disclosed, in whole or in part or in any form, to third parties without the prior written consent of Montana Fire Pits. All information, illustrations, screen shots, and data contained are herein Copyright © Montana Fire Pits. All rights reserved.

**Model:** Canyon Fire Table

**Size:** 65" L x 35" W x 16" H

**Material:** GFRC

**Burner:** CFBL210 - 210K BTU Linear Burner

**Fuel Pressure:** Natural Gas: 7" Water Column  
Propane: 11" Water Column

**Vessel Weight:** 430 lbs.

## Burner Detail

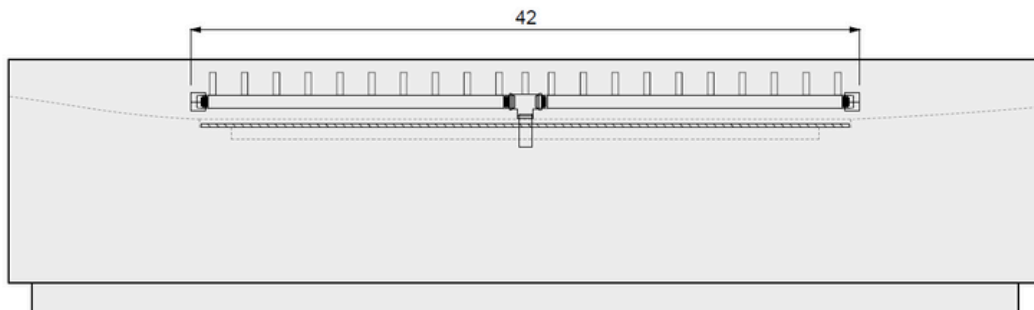

01 SIDE VIEW

## BURNER MODEL

LINEAR CFBL210  
Dimensions: 42" x 1"  
210,000 BTU

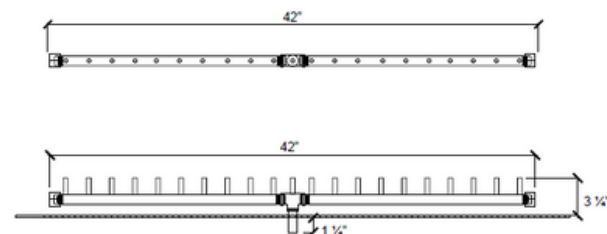

## Plate Detail

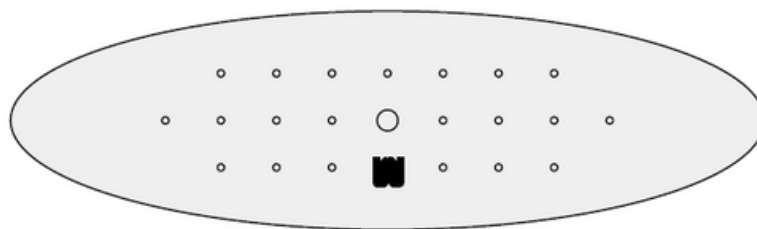

01 TOP VIEW

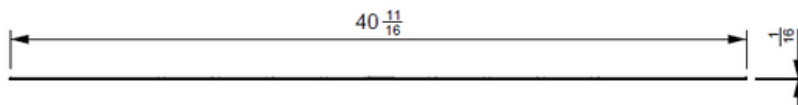

02 FRONT VIEW

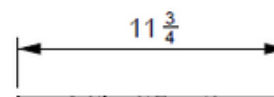

03 SIDE VIEW

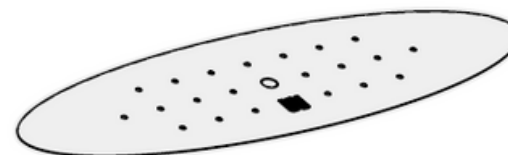

04 PERSPECTIVE



### CONFIDENTIAL

Any information data and drawings embodied in this document are proprietary and strictly confidential, are to be held as confidential and supplied with the understanding that they will not be disclosed, in whole or in part or in any form, to third parties without the prior written consent of Montana Fire Pits. All information, illustrations, screen shots, and data contained are herein Copyright © Montana Fire Pits. All rights reserved.

**Model:** Canyon Fire Table

**Size:** 65" L x 35" W x 16" H

**Material:** GFRC

**Burner:** CFBL210 - 210K BTU Linear Burner

**Fuel Pressure:** Natural Gas: 7" Water Column  
Propane: 11" Water Column

**Vessel Weight:** 430 lbs.

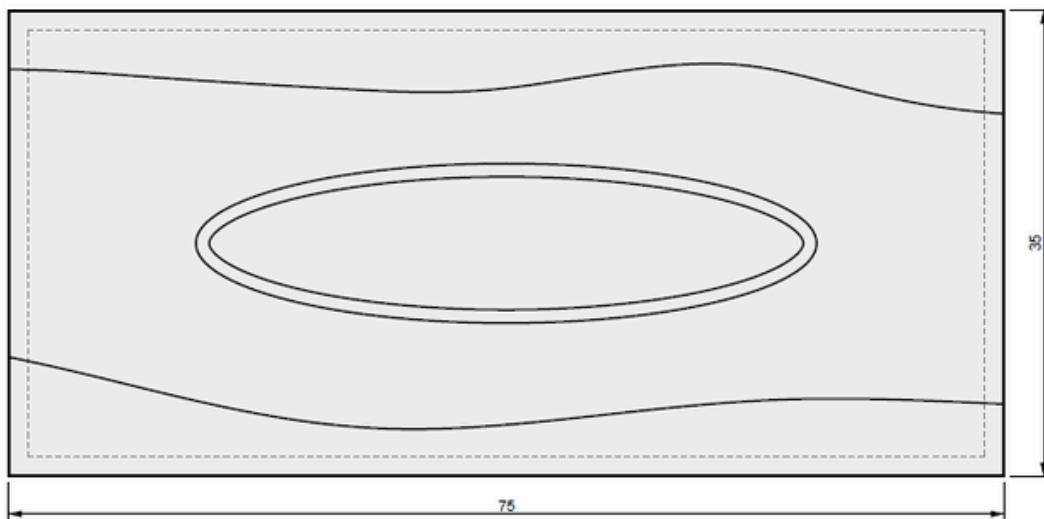

01 TOP VIEW

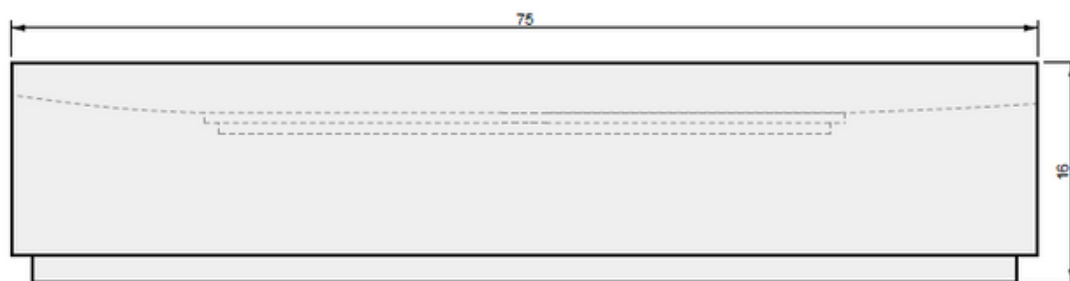

02 FRONT VIEW

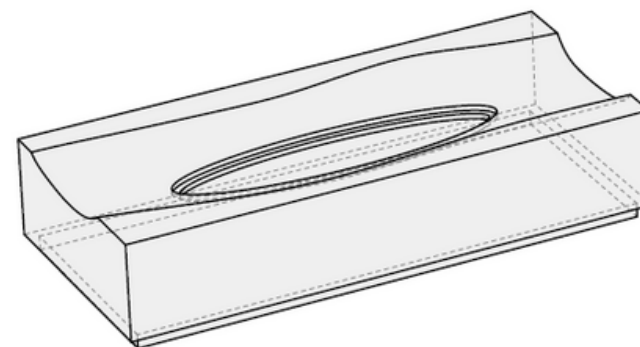

04 PERSPECTIVE

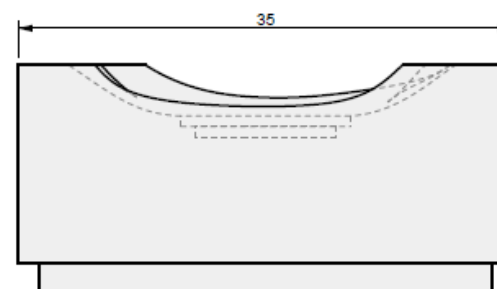

03 SIDE VIEW



**CONFIDENTIAL**

Any information data and drawings embodied in this document are proprietary and strictly confidential, are to be held as confidential and supplied with the understanding that they will not be disclosed, in whole or in part or in any form, to third parties without the prior written consent of Montana Fire Pits. All information, illustrations, screen shots, and data contained are herein Copyright © Montana Fire Pits. All rights reserved.

**Model:** Canyon Fire Table

**Size:** 75" L x 35" W x 16" H

**Material:** GFRC

**Burner:** CFBL250 - 250K BTU Linear Burner

**Fuel Pressure:** Natural Gas: 7" Water Column  
Propane: 11" Water Column

**Vessel Weight:** 480 lbs.

## Burner Detail

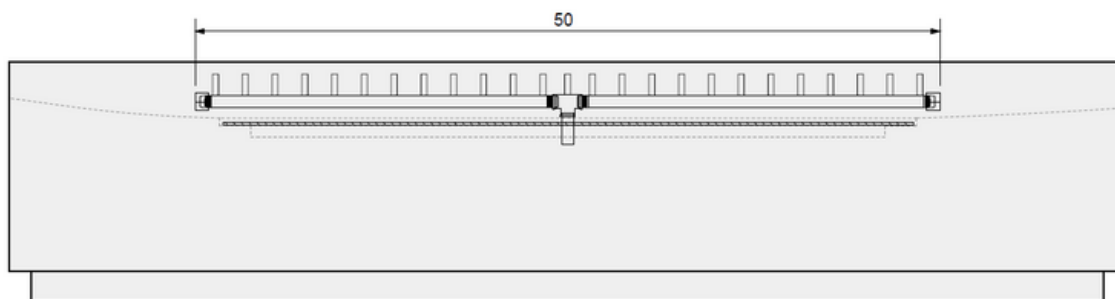

01 SIDE VIEW

### BURNER MODEL

LINEAR CFBL250  
Dimensions: 50" x 1"  
250,000 BTU

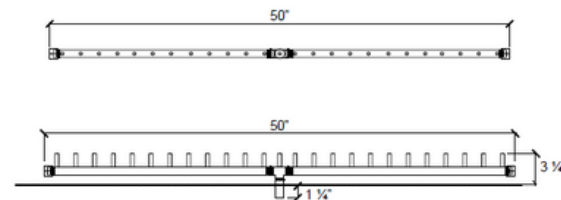

## Plate Detail

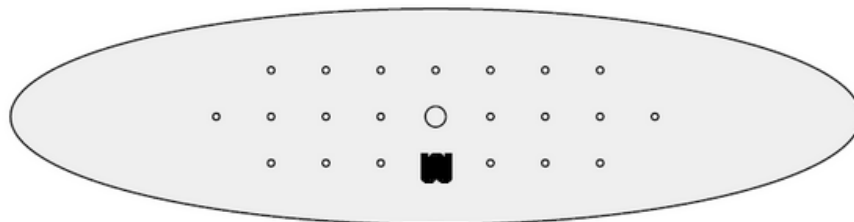

01 TOP VIEW

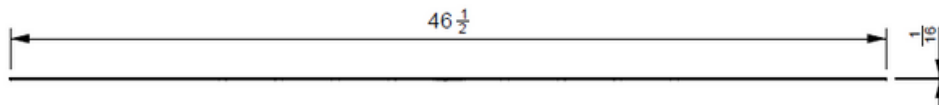

02 FRONT VIEW

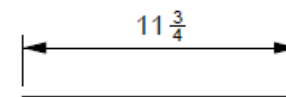

03 SIDE VIEW

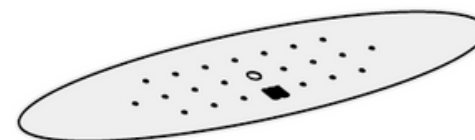

04 PERSPECTIVE



### CONFIDENTIAL

Any information data and drawings embodied in this document are proprietary and strictly confidential, are to be held as confidential and supplied with the understanding that they will not be disclosed, in whole or in part or in any form, to third parties without the prior written consent of Montana Fire Pits. All information, illustrations, screen shots, and data contained are herein Copyright © Montana Fire Pits. All rights reserved.

**Model:** Canyon Fire Table

**Size:** 75" L x 35" W x 16" H

**Material:** GFRC

**Burner:** CFBL250 - 250K BTU Linear Burner

**Fuel Pressure:** Natural Gas: 7" Water Column  
Propane: 11" Water Column

**Vessel Weight:** 480 lbs.

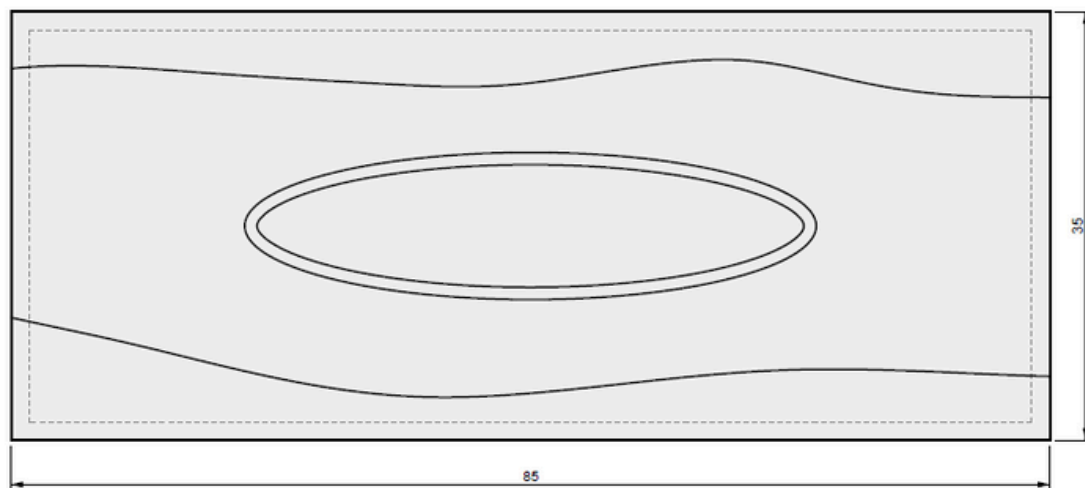

01 TOP VIEW

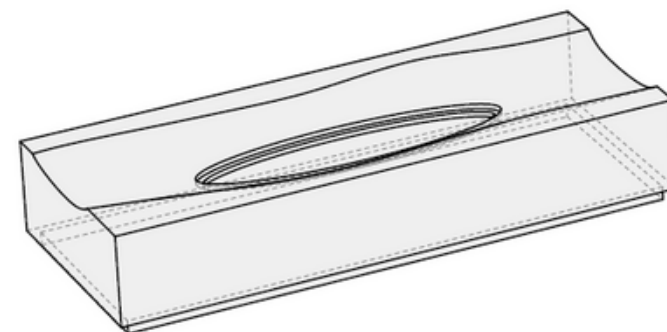

04 PERSPECTIVE

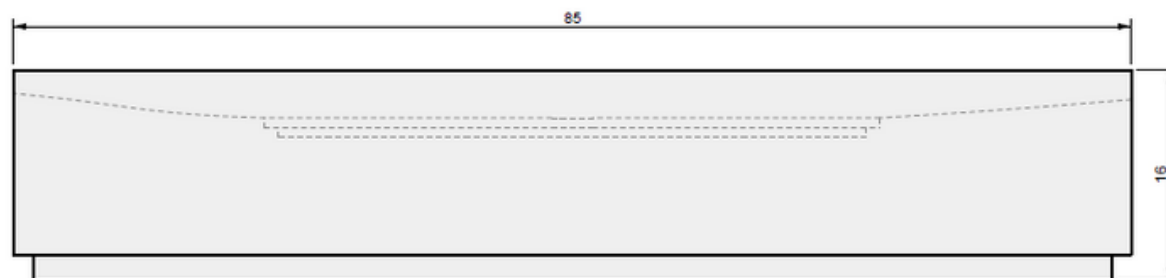

02 FRONT VIEW

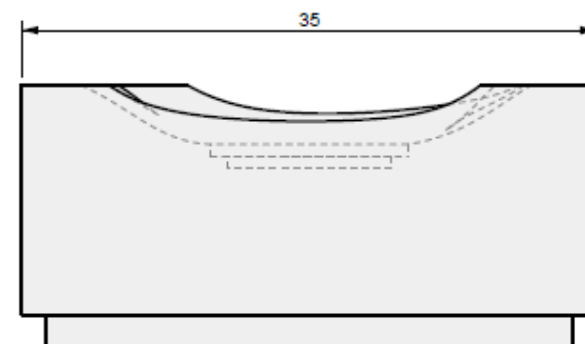

03 SIDE VIEW



**CONFIDENTIAL**

Any information data and drawings embodied in this document are proprietary and strictly confidential, are to be held as confidential and supplied with the understanding that they will not be disclosed, in whole or in part or in any form, to third parties without the prior written consent of Montana Fire Pits. All information, illustrations, screen shots, and data contained are herein Copyright © Montana Fire Pits. All rights reserved.

**Model:** Canyon Fire Table

**Size:** 85" L x 35" W x 16" H

**Material:** GFRC

**Burner:** CFBL270 - 270K BTU Linear Burner

**Fuel Pressure:** Natural Gas: 7" Water Column  
Propane: 11" Water Column

**Vessel Weight:** 530 lbs.

## Burner Detail

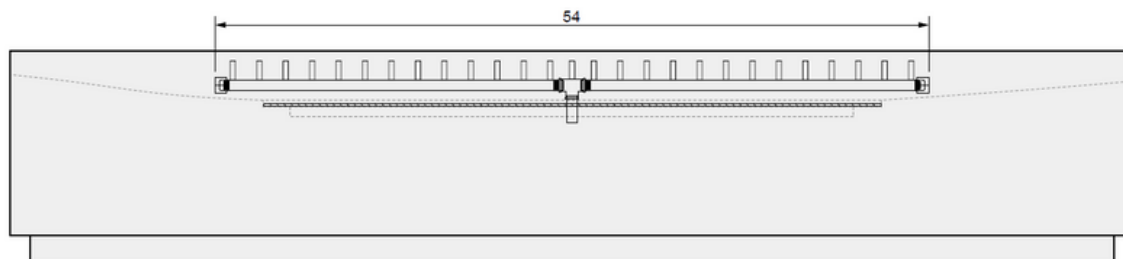

01 SIDE VIEW

### BURNER MODEL

**LINEAR CFBL270**  
Dimensions: 54" x 1"  
270,000 BTU

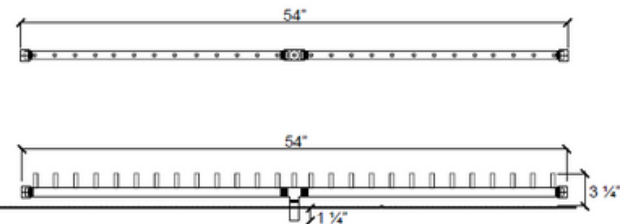

## Plate Detail

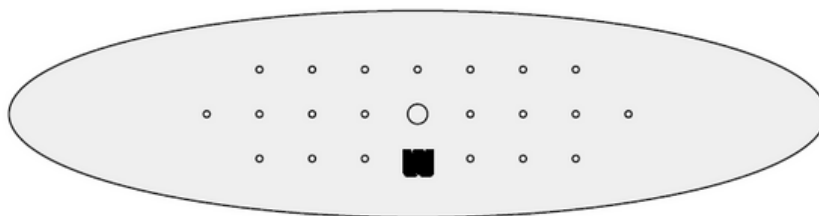

01 TOP VIEW

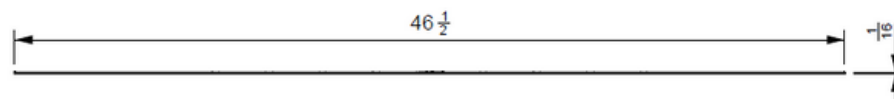

02 FRONT VIEW

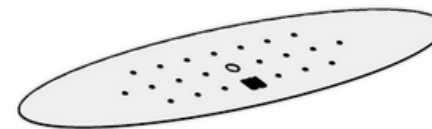

04 PERSPECTIVE

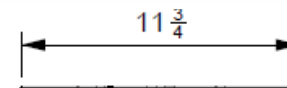

03 SIDE VIEW



### CONFIDENTIAL

Any information data and drawings embodied in this document are proprietary and strictly confidential, are to be held as confidential and supplied with the understanding that they will not be disclosed, in whole or in part or in any form, to third parties without the prior written consent of Montana Fire Pits. All information, illustrations, screen shots, and data contained are herein Copyright © Montana Fire Pits. All rights reserved.

**Model:** Canyon Fire Table

**Size:** 85" L x 35" W x 16" H

**Material:** GFRC

**Burner:** CFBL270 - 270K BTU Linear Burner

**Fuel Pressure:** Natural Gas: 7" Water Column  
Propane: 11" Water Column

**Vessel Weight:** 530 lbs.



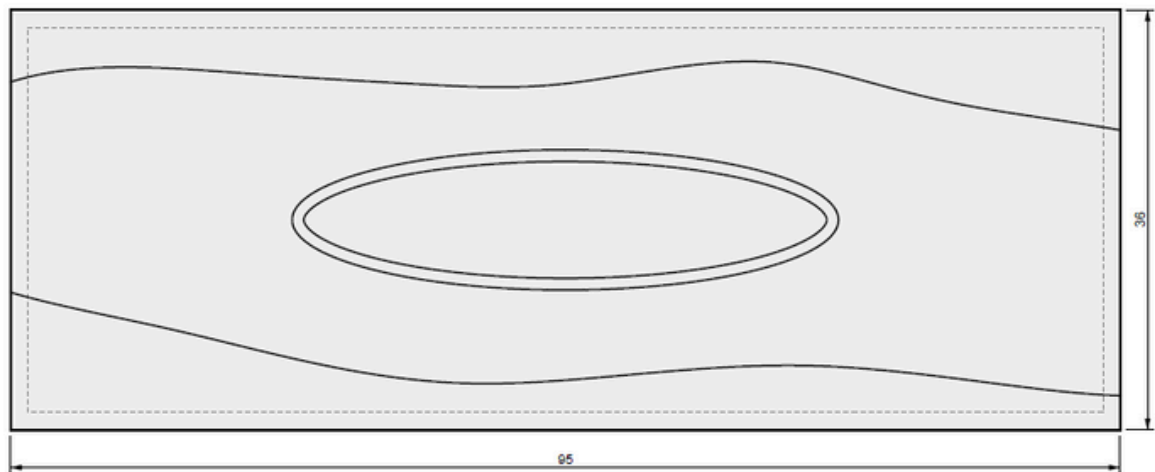

01 TOP VIEW

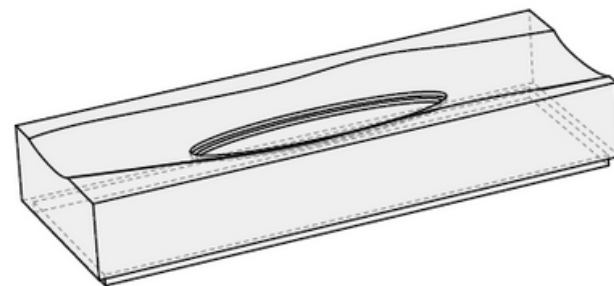

04 PERSPECTIVE

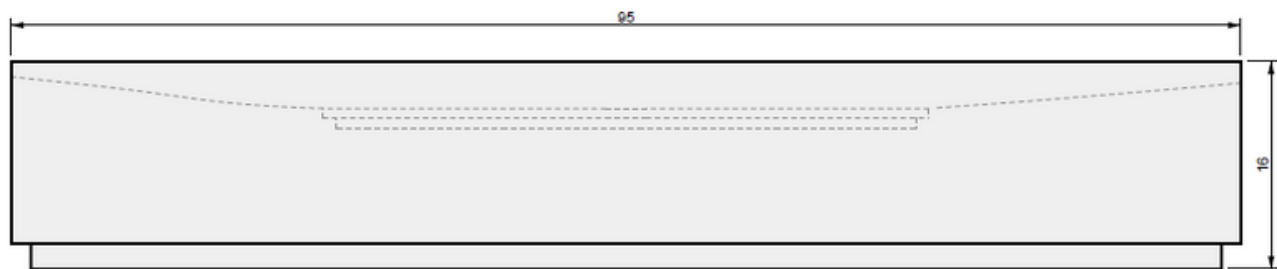

02 FRONT VIEW

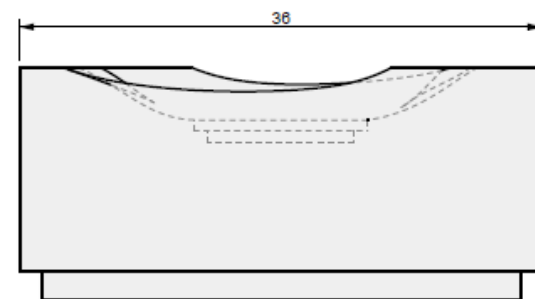

03 SIDE VIEW



**CONFIDENTIAL**

Any information data and drawings embodied in this document are proprietary and strictly confidential, are to be held as confidential and supplied with the understanding that they will not be disclosed, in whole or in part or in any form, to third parties without the prior written consent of Montana Fire Pits. All information, illustrations, screen shots, and data contained are herein Copyright © Montana Fire Pits. All rights reserved.

**Model:** Canyon Fire Table

**Size:** 95" L x 35" W x 16" H

**Material:** GFRC

**Burner:** CFBL270 - 270K BTU Linear Burner

**Fuel Pressure:** Natural Gas: 7" Water Column  
Propane: 11" Water Column

**Vessel Weight:** 580 lbs.

## Burner Detail



01 SIDE VIEW

### BURNER MODEL

LINEAR CFBL270  
Dimensions: 54" x 1"  
270,000 BTU

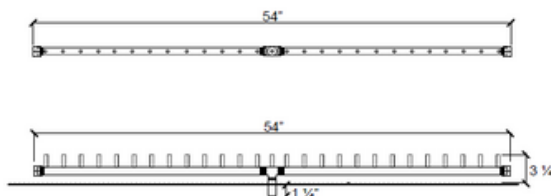

## Plate Detail

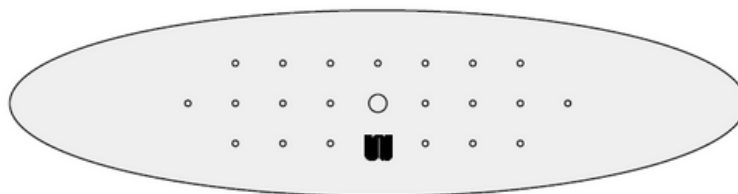

01 TOP VIEW

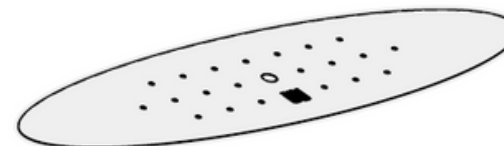

04 PERSPECTIVE

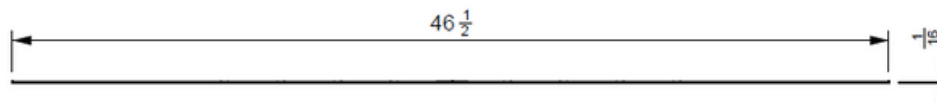

02 FRONT VIEW

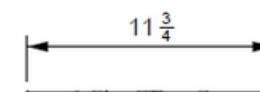

03 SIDE VIEW



### CONFIDENTIAL

Any information data and drawings embodied in this document are proprietary and strictly confidential, are to be held as confidential and supplied with the understanding that they will not be disclosed, in whole or in part or in any form, to third parties without the prior written consent of Montana Fire Pits. All information, illustrations, screen shots, and data contained are herein Copyright © Montana Fire Pits. All rights reserved.

**Model:** Canyon Fire Table

**Size:** 95" L x 35" W x 16" H

**Material:** GFRC

**Burner:** CFBL270 - 270K BTU Linear Burner

**Fuel Pressure:** Natural Gas: 7" Water Column  
Propane: 11" Water Column

**Vessel Weight:** 580 lbs.